













CLAMP

LINE



CLAMP LINE

CLAMP
LINE

	Picture	Description	Page
MAS/BT 403		WELDON TOOLHOLDER DIN 6359 FOR END MILLS DIN 1835-B · FORM AD	214
		POWER MILLING CHUCK	215
		COLLET CHUCKS ER DIN 6499 · FORM AD	216
		SHELL END MILL HOLDERS FOR CUTTERS WITH INTERNAL COOLANT DIN 6357	217
		QUICK CHANGE TAPPING WITH LENGT COMPENSATION ON COMPRESSION AND EXPANSION · FORM A	218
		NC DRILLS CHUCKS FOR CLOCKWISE AND COUNTER CLOCKWISE ROTATION · FORM AD	219
DIN 69871		WELDON TOOLHOLDER DIN 6359 FOR END MILLS DIN 1835-B · FORM AD	220
		POWER MILLING CHUCK	221
		COLLET CHUCKS ER DIN 6499 · FORM AD	222
		SHELL END MILL HOLDER WITH ENLARGED CONTACT FACE AND INTERNAL COOLANT DIN 6357 · FORM AD	223
		QUICK CHANGE TAPPING WITH LENGT COMPENSATION ON COMPRESSION AND EXPANSION · FORM A	224
		NC DRILLS CHUCKS FOR CLOCKWISE AND COUNTER CLOCKWISE ROTATION · FORM AD	225

Picture	Description	Page
	ER COLLET DIN 6499-B	226
	HIGH POWER SEALED COLLETS 100% STEEL	228
	ER COLLET SET DIN 6499-B IN A WOODEN BOX	229
	QUICK-CHANGE HEAD WITH SAFETY CLUTCH	231
	PULL STUD DRILLED WITH O-RING DIN 69872-A	232
	PULL STUD MAS/BT SHORT DRILLED WITH O-RING DIN 69872	232
	PULL STUD DRILLED WITH O-RING ISO 7388-2B	233
	PULL STUD MAS/BT DRILLED WITH O-RING	233
	PULL STUD DRILLED WITH O-RING ISO 7388-2A	234
	PULL STUD OTT DRILLED WITH INTERNAL THREAD DIN 2080	234
	WRENCH FOR ER COLLET CHUCKS	235
	CLAMPING NUT FOR ER COLLET CHUCKS	235

ACCESSORIES

MAS/BT 403

WELDON TOOLHOLDER DIN 6359 FOR END MILLS DIN 1835-B

Portaherramientas Weldon DIN 6359 para fresas DIN 1835-B



Holder type **MAS BT**

Concentricity **>0,003**

Balanced **G 0.3**

Form AD

Information / Spare parts

Información / Recambios



Cod.	SK	d	A (L)	D	Clamping Screw	Kg	Price €
91404.WE106050	BT40	6	50	25	M 6	1,1	
91404.WE108050	BT40	8	50	28	M 8	1,1	
91404.WE110063	BT40	10	63	35	M 10	1,2	
91404.WE112063	BT40	12	63	42	M 12	1,3	
91404.WE114063	BT40	14	63	44	M 12	1,3	
91404.WE116063	BT40	16	63	48	M 14	1,4	
91404.WE118063	BT40	18	63	50	M 14	1,4	
91404.WE120063	BT40	20	63	52	M 16	1,4	
91404.WE125090	BT40	25	90	65	M 18x2	2,2	
91404.WE132100	BT40	32	100	72	M 20x2	2,7	
91404-WE140105	BT40	40	105	80	M 20x 2	2,8	

Cod.	SK	d	A (L)	D	Clamping Screw	Kg	Price €
91504.WE106063	BT50	6	63	25	M 6	3,7	
91504.WE108063	BT50	8	63	28	M 8	3,8	
91504.WE110080	BT50	10	80	35	M 10	3,8	
91504.WE112080	BT50	12	80	42	M 12	4,0	
91504.WE114080	BT50	14	80	44	M 12	4,0	
91504.WE116080	BT50	16	80	48	M 14	4,0	
91504.WE118080	BT50	18	80	50	M 14	4,0	
91504.WE120080	BT50	20	80	52	M 16	4,1	
91504.WE125100	BT50	25	100	65	M 18x2	4,7	
91504.WE132105	BT50	32	105	72	M 20x2	5,1	
91504.WE140115	BT50	40	115	80	M 20x2	5,3	

MAS/BT 403

POWER MILLING CHUCK

Portapinzas de gran apriete

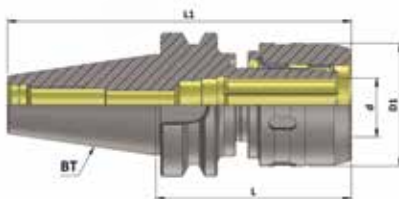

Holder type

MAS
BT

Concentricity



Balanced



Form AD



Information / Spare parts Información / Recambios

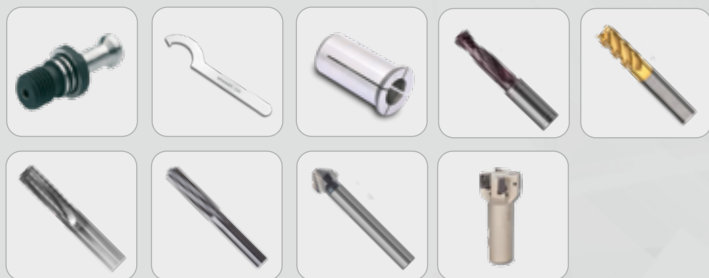

Cod.	SK	d	A (L)	D1	L1	Kg	Price €
91404.KR120080	BT 40	20	80	54	145	1,3	
91404.KR132090	BT 40	32	90	74	155	1,2	
91504.KR120105	BT 50	20	105	54	212	2,3	
91504.KR132105	BT 50	32	105	74	212	2,3	

MAS/BT 403

COLLET CHUCKS ER DIN 6499

Portapinzas ER DIN 6499

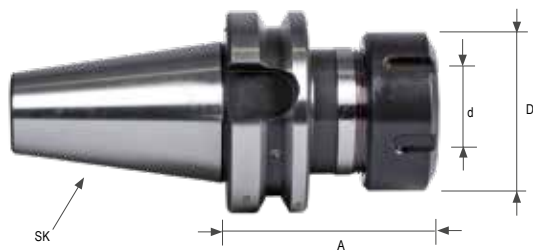

Holder type

MAS
BT

Concentricity



Balanced



Form AD



Information / Spare parts
Información / Recambios



Cod.	SK	d	A (L)	D	Range	Stop Screw	Kg	Price €
91404.ER116070	BT 40	ER 16	70	32	1-10	M 10x1	1,1	
91404.ER116100	BT 40	ER 16	100	32	1-10	M 10x1	1,2	
91404.ER116160	BT 40	ER 16	160	32	1-10	M 10x1	1,6	
91404.ER125070	BT 40	ER 25	70	42	1-16	M 18x1	1,2	
91404.ER125100	BT 40	ER 25	100	42	1-16	M 18x1	1,3	
91404.ER125160	BT 40	ER 25	160	42	1-16	M 18x1	1,6	
91404.ER132070	BT 40	ER 32	70	50	2-20	M 22x1,5	1,2	
91404.ER132100	BT 40	ER 32	100	50	2-20	M 22x1,5	1,4	
91404.ER132160	BT 40	ER 32	160	50	2-20	M 22x1,5	1,9	
91404.ER140070	BT 40	ER 40	70	63	3-26	M 30x1,5	1,2	
91404.ER140100	BT 40	ER 40	100	63	3-26	M 30x1,5	1,8	
91404.ER140160	BT 40	ER 40	160	63	3-26	M 30x1,5	2,4	
91504.ER216100	BT 50	ER 16	100	32	1-10	M 10x1	3,7	
91504.ER225100	BT 50	ER 25	100	42	1-16	M 18x1	3,8	
91504.ER232100	BT 50	ER 32	100	50	2-20	M 22x1,5	3,9	
91504.ER240100	BT 50	ER 40	100	63	3-26	M 30x1,5	4,3	

MAS/BT 403

SHELL END MILL HOLDER FOR CUTTERS WITH INTERNAL COOLANT DIN 6357

Portafresas con chaveta frontal y refrigeración interior DIN 6357



Holder type

MAS
BT

Concentricity



Balanced



Form AD+B



Information / Spare parts

Información / Recambios



Cod.	SK	d	A (L)	D1	L2	Kg	Price €
91404.AS316045	BT 40	16	45	38	17	1,0	
91404.AS316100	BT 40	16	100	38	17	1,3	
91404.AS316160	BT 40	16	160	38	17	1,6	
91404.AS322045	BT 40	22	45	48	19	1,2	
91404.AS322100	BT 40	22	100	48	19	1,4	
91404.AS322160	BT 40	22	160	48	19	1,6	
91404.AS327045	BT 40	27	45	58	21	1,2	
91404.AS327100	BT 40	27	100	58	21	1,4	
91404.AS332050	BT 40	32	50	78	24	1,4	
91404.AS332100	BT 40	32	100	78	24	1,7	
91404.AS340055	BT 40	40	55	88	27	2,0	
91404.AS340100	BT 40	40	100	88	27	2,4	

Cod.	SK	d	A (L)	D1	L2	Kg	Price €
91504.AS316060	BT 50	16	60	38	17	3,7	
91504.AS316100	BT 50	16	100	38	17	4,0	
91504.AS316160	BT 50	16	160	38	17	5,1	
91504.AS322060	BT 50	22	60	48	19	3,8	
91504.AS322100	BT 50	22	100	48	19	4,0	
91504.AS322160	BT 50	22	160	48	19	6,0	
91504.AS327060	BT 50	27	60	58	21	3,9	
91504.AS327100	BT 50	27	100	58	21	4,3	
91504.AS327160	BT 50	27	160	58	21	6,1	
91504.AS332060	BT 50	32	60	78	24	4,1	
91504.AS332100	BT 50	32	100	78	24	4,3	
91504.AS332160	BT 50	32	160	78	24	6,9	
91504.AS340060	BT 50	40	60	88	27	4,5	
91504.AS340100	BT 50	40	100	88	27	4,7	
91504.AS340160	BT 50	40	160	88	27	7,8	

MAS/BT 403

QUICK CHANGE TAPPING WITH LENGT COMPENSATION ON COMPRESSION AND EXPANSION

Rosgador de cambio rápido – doble compensación axial



Holder type

**MAS
BT**

Form A



Axial



Information / Spare parts

Información / Recambios



Cod.	SK	Size	A	D	d	M	Kg	Price €
91404.GML0GR1	BT 40	1	60	36	19	M3-M12	1,2	
91404.GML0GR2	BT 40	2	98	53	31	M6-M27	1,3	
91504.GML0GR1	BT 50	1	77	36	19	M3-M12	4,0	
91504.GML0GR2	BT 50	2	102,5	53	31	M6-M27	4,3	

MAS/BT 403

NC DRILLS CHUCKS FOR CLOCKWISE AND COUNTER CLOCKWISE ROTATION

Portabrocas integral CNC para giro a derecha e izquierda



Holder type

MAS
BT

Concentricity

>0,003<

Balanced

G6.3
G0.1
G0.04

Form AD

Form AD

Information / Spare parts

Información / Recambios



Cod.	SK	Range d	A	D	Kg	Price €
91404.BF2113	BT 40	1-13	81	50	1,8	
91404.BF2316	BT 40	3-16	88	57	1,9	
91504.BF2113	BT 50	1-13	90	50	4,5	
91504.BF2316	BT 50	3-16	95	57	4,6	

DIN 69871

WELDON TOOLHOLDER DIN 6359 FOR END MILLS DIN 1835-B

Portaherramientas Weldon DIN 6359 para fresas DIN 1835-B



Holder type



Concentricity



Balanced



Form AD



Information / Spare parts

Información / Recambios



Cod.	SK	d	A (L)	D1	Clamping Screw	Kg	Price €
91406.WE106050	SK 40	6	50	25	M 6	0,9	
91406.WE108050	SK 40	8	50	28	M 8	1,0	
91406.WE110050	SK 40	10	50	35	M 10	1,0	
91406.WE112050	SK 40	12	50	42	M 12	1,1	
91406.WE114050	SK 40	14	50	44	M 12	1,1	
91406.WE116063	SK 40	16	63	48	M 14	1,3	
91406.WE118063	SK 40	18	63	50	M 14	1,3	
91406.WE120063	SK 40	20	63	52	M 16	1,3	
91406.WE125100	SK 40	25	100	65	M 18x2	2,3	
91406.WE132100	SK 40	32	100	72	M 20x2	2,5	
91406.WE140115	SK 40	40	115	80	M 20x2	3,3	

Cod.	SK	d	A (L)	D1	Clamping Screw	Kg	Price €
91506.WE106063	SK 50	6	63	25	M 6	2,8	
91506.WE108063	SK 50	8	63	28	M 8	2,8	
91506.WE110063	SK 50	10	63	35	M 10	2,9	
91506.WE112063	SK 50	12	63	42	M 12	3,0	
91506.WE114063	SK 50	14	63	44	M 12	3,0	
91506.WE116063	SK 50	16	63	48	M 14	3,1	
91506.WE118063	SK 50	18	63	50	M 14	3,1	
91506.WE120063	SK 50	20	63	52	M 16	3,1	
91506.WE125080	SK 50	25	80	65	M 18x2	3,8	
91506.WE132100	SK 50	32	100	72	M 20x2	4,5	
91506.WE140120	SK 50	40	120	80	M 20x2	5,0	

DIN 69871

POWER MILLING CHUCK

Portapinzas de gran apriete

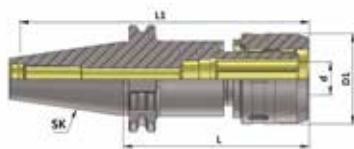

Holder type

**DIN
69871**

Concentricity



Balanced



Form AD



Information / Spare parts
Información / Recambios



Cod.	SK	d	A (L)	D1	L1	Kg	Price €
91406.KR120105	SK 40	20	105	54	173	1,4	
91406.KR132105	SK 40	32	105	72	173	1,4	
91506.KR120105	SK 50	20	105	54	206	2,4	
91506.KR132105	SK 50	32	105	72	206	2,4	

DIN 69871

COLLET CHUCKS ER DIN 6499

Portapinzas ER DIN 6499

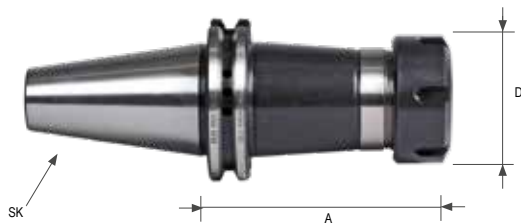

Holder type **DIN 69871**

Concentricity **>0,003**

Balanced **G 0.3**

Form AD

Information / Spare parts
Información / Recambios



Cod.	SK	ER	A (L)	D1	Clamping Range	Stop Screw	Kg	Price €
91406.ER116070	SK 40	ER 16	70	32	1-10	M10X1	0,9	
91406.ER116100	SK 40	ER 16	100	32	1-10	M10X1	1,1	
91406.ER116160	SK 40	ER 16	160	32	1-10	M10X1	1,5	
91406.ER125070	SK 40	ER 25	70	42	2-16	M18X1	1,0	
91406.ER125100	SK 40	ER 25	100	42	2-16	M18X1	1,1	
91406.ER125160	SK 40	ER 25	160	42	2-16	M18X1	1,7	
91406.ER132070	SK 40	ER 32	70	50	2-20	M22X1,5	1,0	
91406.ER132100	SK 40	ER 32	100	50	2-20	M22X1,5	1,3	
91406.ER132160	SK 40	ER 32	160	50	2-20	M22X1,5	1,8	
91406.ER140070	SK 40	ER 40	70	63	3-26	M30X1,5	1,2	
91406.ER140100	SK 40	ER 40	100	63	3-26	M30X1,5	1,7	
91406.ER140160	SK 40	ER 40	160	63	3-26	M30X1,5	2,5	
91506.ER116100	SK 50	ER 16	100	32	1-10	M10X1	2,9	
91506.ER125100	SK 50	ER 25	100	42	1-16	M18X1	3,1	
91506.ER132100	SK 50	ER 32	100	50	2-20	M22X1,5	3,2	
91506.ER140100	SK 50	ER 40	100	63	3-26	M30X1,5	3,4	

DIN 69871

SHELL END MILL HOLDER WITH ENLARGED CONTACT FACE AND INTERNAL COOLANT DIN 6357

Portafresas con chaveta frontal y refrigeración interior DIN 6357

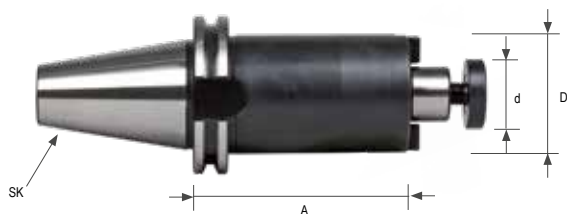

Holder type

DIN
69871

Concentricity

>0,003

Balanced

G6.3
G0.1
G0.04

Form AD+B



Information / Spare parts

Información / Recambios



Cod.	SK	d	A (L)	D1	L2	Kg	Price €
91406.AS316045	SK40	16	45	38	17	1,0	
91406.AS322045	SK40	22	45	48	19	1,1	
91406.AS322100	SK40	22	100	48	19	1,6	
91406.AS327050	SK40	27	50	58	21	1,1	
91406.AS327100	SK40	27	100	58	21	1,9	
91406.AS332055	SK40	32	55	78	24	1,7	
91406.AS340055	SK40	40	55	88	27	1,9	

Cod.	SK	d	A (L)	D1	L2	Kg	Price €
91506.AS316045	SK50	16	45	38	17	2,8	
91506.AS322045	SK50	22	45	48	19	2,9	
91506.AS322100	SK50	22	100	48	19	3,6	
91506.AS327045	SK50	27	45	58	21	3,1	
91506.AS327100	SK50	27	100	58	21	4,1	
91506.AS332050	SK50	32	50	78	24	3,9	
91506.AS340055	SK50	40	55	88	27	4,1	

DIN 69871

QUICK CHANGE TAPPING WITH LENG COMPENSATION ON COMPRESSION AND EXPANSION

Rosgador de cambio rápido – doble compensación axial

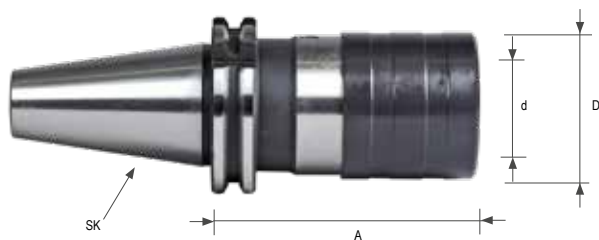

Holder type **DIN 69871**

Form A



Axial



Information / Spare parts

Información / Recambios



Cod.	SK	Size	A (L)	D1	d	M	Kg	Price €
91406.GML0GR1	SK40	1	60	36	19	M3-M12	0,8	
91406.GML0GR2	SK40	2	98	53	31	M6-M27	1,8	
91506.GML0GR1	SK50	1	60	36	19	M3-M12	2,6	
91506.GML0GR2	SK50	2	84	53	31	M6-M27	3,6	

DIN 69871

NC DRILLS CHUCKS FOR CLOCKWISE AND COUNTER CLOCKWISE ROTATION

Portabrocas integral CNC para giro a derecha e izquierda



Holder type

DIN
69871

Concentricity

>0,003

Balanced

G6.3
50%
G4

Form AD



Information / Spare parts

Información / Recambios



Cod.	SK	Clamping	A (L)	D	Kg	Price €
91406.BF2113	SK 40	1-13	81	50	1,6	
91406.BF2316	SK 40	3-16	88	57	2,2	
91506.BF2113	SK 50	1-13	90	50	3,4	
91506.BF2316	SK 50	3-16	95	57	3,5	

ACCESSORIES

ER COLLET DIN 6499-B

Pinzas ER DIN 6499-B

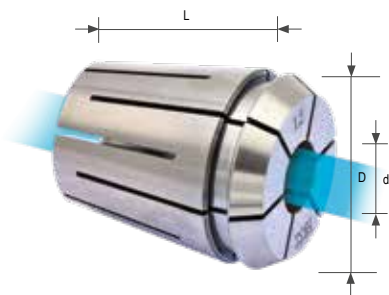

PRECISION SEALED 100% STEEL

High pressure approved 120 Bar

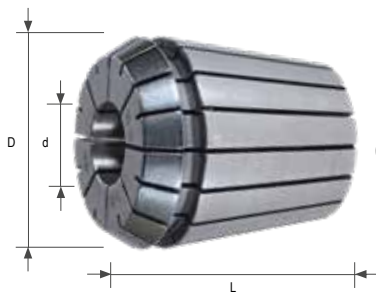

STANDARD

Holder type

DIN
6499

Concentricity



Information / Spare parts

Información / Recambios



SEALED 100% STEEL

Cod.	Size	d	D1	L	Kg	Price €
ER25SC0600	ER 25	6	26	35	0,09	
ER25SC0800	ER 25	8	26	35	0,09	
ER25SC1000	ER 25	10	26	35	0,09	
ER25SC1200	ER 25	12	26	35	0,09	
ER25SC1400	ER 25	14	26	35	0,09	
ER25SC1600	ER 25	16	26	35	0,09	
ER32SC0600	ER 32	6	33	40	0,12	
ER32SC0800	ER 32	8	33	40	0,12	
ER32SC1000	ER 32	10	33	40	0,12	
ER32SC1200	ER 32	12	33	40	0,12	
ER32SC1400	ER 32	14	33	40	0,12	
ER32SC1600	ER 32	16	33	40	0,12	
ER32SC1800	ER 32	18	33	40	0,12	
ER32SC2000	ER 32	20	33	40	0,12	

STANDARD

Cod.	Size	d	D1	L	Kg	Price €
93ER16.1,0	ER 16-426 E	1,0	17	27,5	0,07	
93ER16.2,0	ER 16-426 E	2,0	17	27,5	0,07	
93ER16.3,0	ER 16-426 E	3,0	17	27,5	0,07	
93ER16.4,0	ER 16-426 E	4,0	17	27,5	0,07	
93ER16.5,0	ER 16-426 E	5,0	17	27,5	0,07	
93ER16.6,0	ER 16-426 E	6,0	17	27,5	0,07	
93ER16.7,0	ER 16-426 E	7,0	17	27,5	0,07	
93ER16.8,0	ER 16-426 E	8,0	17	27,5	0,07	
93ER16.9,0	ER 16-426 E	9,0	17	27,5	0,07	
93ER16.10,0	ER 16-426 E	10,0	17	27,5	0,07	

Cod.	Size	d	D1	L	Kg	Price €
93ER32.2,0	ER 32-470 E	2,0-1,0	33	40	0,12	
93ER32.3,0	ER 32-470 E	3,0-2,0	33	40	0,12	
93ER32.4,0	ER 32-470 E	4,0-3,0	33	40	0,12	
93ER32.5,0	ER 32-470 E	5,0-4,0	33	40	0,12	
93ER32.6,0	ER 32-470 E	6,0-5,0	33	40	0,12	
93ER32.7,0	ER 32-470 E	7,0-6,0	33	40	0,12	
93ER32.8,0	ER 32-470 E	8,0-7,0	33	40	0,12	
93ER32.9,0	ER 32-470 E	9,0-8,0	33	40	0,12	
93ER32.10,0	ER 32-470 E	10,0-9,0	33	40	0,12	
93ER32.11,0	ER 32-470 E	11,0-10,0	33	40	0,12	
93ER32.12,0	ER 32-470 E	12,0-11,0	33	40	0,12	
93ER32.13,0	ER 32-470 E	13,0-12,0	33	40	0,12	
93ER32.14,0	ER 32-470 E	14,0-13,0	33	40	0,12	
93ER32.15,0	ER 32-470 E	15,0-14,0	33	40	0,12	
93ER32.16,0	ER 32-470 E	16,0-15,0	33	40	0,12	
93ER32.17,0	ER 32-470 E	17,0-16,0	33	40	0,12	
93ER32.18,0	ER 32-470 E	18,0-17,0	33	40	0,12	
93ER32.19,0	ER 32-470 E	19,0-18,0	33	40	0,12	
93ER32.20,0	ER 32-470 E	20,0-19,0	33	40	0,12	

Cod.	Size	d	D1	L	Kg	Price €
93ER25.1,0	ER 25-430 E	1,0-0,5	26	34	0,09	
93ER25.2,0	ER 25-430 E	2,0-1,0	26	34	0,09	
93ER25.3,0	ER 25-430 E	3,0-2,0	26	34	0,09	
93ER25.4,0	ER 25-430 E	4,0-3,0	26	34	0,09	
93ER25.5,0	ER 25-430 E	5,0-6,0	26	34	0,09	
93ER25.6,0	ER 25-430 E	6,0-7,0	26	34	0,09	
93ER25.7,0	ER 25-430 E	7,0-8,0	26	34	0,09	
93ER25.8,0	ER 25-430 E	8,0-7,0	26	34	0,09	
93ER25.9,0	ER 25-430 E	9,0-8,0	26	34	0,09	
93ER25.10,0	ER 25-430 E	10,0-9,0	26	34	0,09	
93ER25.11,0	ER 25-430 E	11,0-10,0	26	34	0,09	
93ER25.12,0	ER 25-430 E	12,0-11,0	26	34	0,09	
93ER25.13,0	ER 25-430 E	13,0-12,0	26	34	0,09	
93ER25.14,0	ER 25-430 E	14,0-13,0	26	34	0,09	
93ER25.15,0	ER 25-430 E	15,0-14,0	26	34	0,09	
93ER25.16,0	ER 25-430 E	16,0-15,0	26	34	0,09	

Cod.	Size	d	D1	L	Kg	Price €
93ER40.3,0	ER 40-472 E	3,0-2,0	41	46	0,15	
93ER40.4,0	ER 40-472 E	4,0-3,0	41	46	0,15	
93ER40.5,0	ER 40-472 E	5,0-4,0	41	46	0,15	
93ER40.6,0	ER 40-472 E	6,0-5,0	41	46	0,15	
93ER40.7,0	ER 40-472 E	7,0-6,0	41	46	0,15	
93ER40.8,0	ER 40-472 E	8,0-7,0	41	46	0,15	
93ER40.9,0	ER 40-472 E	9,0-2,8	41	46	0,15	
93ER40.10,0	ER 40-472 E	10,0-9,0	41	46	0,15	
93ER40.11,0	ER 40-472 E	11,0-10,0	41	46	0,15	
93ER40.12,0	ER 40-472 E	12,0-11,0	41	46	0,15	
93ER40.13,0	ER 40-472 E	13,0-12,0	41	46	0,15	
93ER40.14,0	ER 40-472 E	14,0-13,0	41	46	0,15	
93ER40.15,0	ER 40-472 E	15,0-14,0	41	46	0,15	
93ER40.16,0	ER 40-472 E	16,0-15,0	41	46	0,15	
93ER40.17,0	ER 40-472 E	17,0-16,0	41	46	0,15	
93ER40.18,0	ER 40-472 E	18,0-17,0	41	46	0,15	
93ER40.19,0	ER 40-472 E	19,0-18,0	41	46	0,15	
93ER40.20,0	ER 40-472 E	20,0-19,0	41	46	0,15	
93ER40.21,0	ER 40-472 E	21,0-20,0	41	46	0,15	
93ER40.22,0	ER 40-472 E	22,0-21,0	41	46	0,15	
93ER40.23,0	ER 40-472 E	23,0-22,0	41	46	0,15	
93ER40.24,0	ER 40-472 E	24,0-23,0	41	46	0,15	
93ER40.25,0	ER 40-472 E	25,0-24,0	41	46	0,15	
93ER40.26,0	ER 40-472 E	26,0-25,0	41	46	0,15	

ACCESSORIES

HIGH POWER SEALED COLLETS 100% STEEL

Pinzas de gran apriete herméticas 100% acero

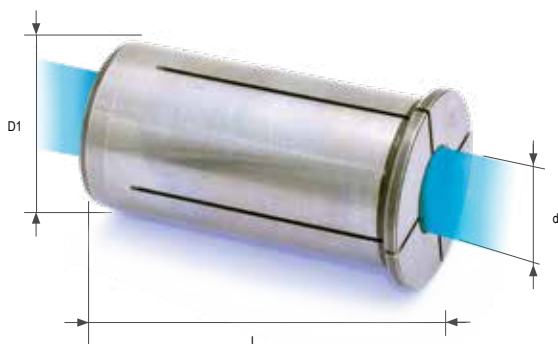

Holder type

DIN
6499

Concentricity



Information / Spare parts

Información / Recambios

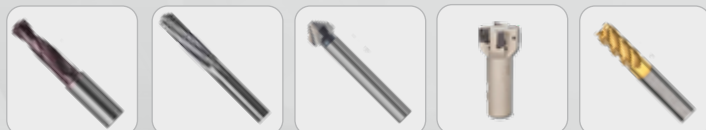

Cod.	Size	d	L	D1	kg	Price €
93HPSC.2006	20	6	52,5	20	0,15	
93HPSC.2008	20	8	52,5	20	0,15	
93HPSC.2010	20	10	52,5	20	0,15	
93HPSC.2012	20	12	52,5	20	0,15	
93HPSC.2014	20	14	52,5	20	0,15	
93HPSC.2016	20	16	52,5	20	0,15	
93HPSC.3206	32	6	64,5	32	0,2	
93HPSC.3208	32	8	64,5	32	0,2	
93HPSC.3210	32	10	64,5	32	0,2	
93HPSC.3212	32	12	64,5	32	0,2	
93HPSC.3214	32	14	64,5	32	0,2	
93HPSC.3216	32	16	64,5	32	0,2	
93HPSC.3218	32	18	64,5	32	0,2	
93HPSC.3220	32	20	64,5	32	0,2	
93HPSC.3225	32	25	64,5	32	0,2	

ACCESSORIES

ER COLLET SET DIN 6499-B IN A WOODEN BOX
AND 1 MM INCREMENTS

Juego de pinzas ER DIN 6499-B en caja de madera e intervalos de 1mm



Standard grade



Cod.	Description	Size	No. collets	Kg	Price €
93SATZER16	Collets set ER16 Ø 1 - 10mm	ER 16	10	1,1	
93SATZER25	Collets set ER25 Ø 2 - 16mm	ER 25	15	1,5	
93SATZER32	Collets set ER32 Ø 3 - 20mm	ER 32	18	1,9	
93SATZER40	Collets set ER40 Ø 4 - 26mm	ER 40	23	2,1	

Ultra precision grade "AA"



Cod.	Description	Size	No. collets	Kg	Price €
93SATZER16UP	Collets set ER16 Ø 1 - 10mm	ER 16	10	1,1	
93SATZER25UP	Collets set ER25 Ø 2 - 16mm	ER 25	15	1,5	
93SATZER32UP	Collets set ER32 Ø 3 - 20mm	ER 32	18	1,9	

QUICK CHANGE TAPPING HEAD TABLE

Tabla adaptación portamachos de cambio rápido



mm x mm Ø x □	DIN 376	DIN 371	Connection size / Tamaño		
	Slim shank mango delgado	Reinforced shank mango reforzado	1 M3-M14	2 M8-M24	3 M14-M36
Rear Connection Diameter / Diámetro conexión posterior			Ø19	Ø31	Ø48
2,5 x 2,1	M: 3,5	M: 1/1,1 / 1,2 / 1,6 / 1,7 / 1,8	○		
2,8 x 2,1	M: 3,5	M: 2 / 2,2 / 2,5 / 2,6	○		
3,5 x 2,7	M: 4,5 / 5	M: 3	●		
4 x 3	M:-----	M: 3,5	●		
4,5 x 3,4	M: 6	M: 4	●	○	
5,5 x 4,3	M: 7	M:-----	●	○	
6 x 4,9	M: 8	M: 4,5 / 5 / 6	●	○	
7 x 5,5	M: 9/10 G1/8	M: 7	○	○	
8 x 6,2	M: 11	M: 8	●	●	
9 x 7	M: 12	M: 9	●	●	
10 x 8	M:-----	M: 10	●	●	
11 x 9	M: 14 G1/4	M:-----	●	●	○
12 x 9	M: 16 G3/8	M:-----	●	●	○
14 x 11	M:18	M:-----		●	○
16 x 12	M: 20 G1/2	M:-----		●	○
18 x 14,5	M: 22/24 G5/8	M:-----		●	○
20 x 16	M: 27 G3/4	M:-----		●	○
22 x 18	M:30 G7/8	M:-----			○
25 x 20	M: 33 G1"	M:-----			○
28 x 22	M: 36	M:-----			○
32 x 24	M: 39/42	M:-----			
36 x 29	M: 45/48	M:-----			

● Available sizes / Medidas disponibles

○ On demand / Bajo pedido

ACCESSORIES

QUICK-CHANGE HEAD WITH SAFETY CLUTCH

Portamachos de cambio rápido con embrague de seguridad



Information / Spare parts

Información / Recambios



Cod.	Size	M	ø	□	d	D	L1	Kg	Price €
93GMS1.35M03371	1	M 3	3,5	2,7	19	32	25	0,6	
93GMS1.45M04371	1	M 4	4,5	3,4	19	32	25	0,6	
93GMS1.60M05371	1	M 5	6,0	4,9	19	32	25	0,6	
93GMS1.60M06371	1	M 6	6,0	4,9	19	32	25	0,6	
93GMS1.80M08371	1	M 8	8,0	6,2	19	32	25	0,6	
93GMS1.10M10371	1	M 10	10,0	8,0	19	32	25	0,6	
93GMS1.90M12376	1	M 12	9,0	7,0	19	32	25	0,6	
93GMS1.11M14376	1	M 14	11,0	9,0	19	32	25	0,6	
93GMS2.80M08371	2	M 8	8,0	6,2	31	50	34	1,6	
93GMS2.10M10371	2	M 10	10,0	8,0	31	50	34	1,6	
93GMS2.90M12376	2	M 12	9,0	7,0	31	50	34	1,6	
93GMS2.11M14376	2	M 14	11,0	9,0	31	50	34	1,6	
93GMS2.12M16376	2	M 16	12,0	9,0	31	50	34	1,6	
93GMS2.14M18376	2	M 18	14,0	11,0	31	50	34	1,6	
93GMS2.16M20376	2	M 20	16,0	12,0	31	50	34	1,6	
93GMS2.18M22376	2	M 22	18,0	14,5	31	50	34	1,6	
93GMS2.18M24376	2	M 24	18,0	14,5	31	50	34	1,6	
93GMS2.20M27376	2	M 27	20,0	16,0	31	50	34	1,6	

ACCESSORIES

PULL STUD DRILLED WITH O-RING DIN 69872-A

Tirante con agujero pasante y junta tórica DIN 69872-A

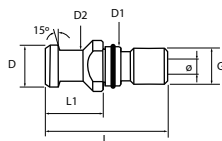

Cod.	ISO	G	α	D	D1	D2	ϕ	L	L1	Kg	Price €
93470.43527	SK 40	M16	15°	19	17	14	7	54	26	0,1	
93470.43528	SK 50	M24	15°	28	25	21	11,5	74	34	0,25	

ACCESSORIES

PULL STUD MAS/BT SHORT DRILLED WITH O-RING DIN 69872

Tirante MAS/BT corto con agujero pasante y junta tórica DIN 69872

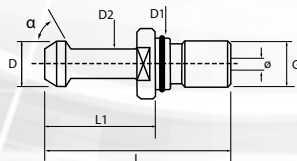

Cod.	ISO	G	α	D	D1	D2	ϕ	L	L1	Kg	Price €
93470.44434	BT 40	M16	60°	15	17	10	4	57	32	0,23	
93470.44435	BT 40	M16	45°	15	17	10	4	57	32	0,23	

ACCESSORIES

PULL STUD DRILLED WITH O-RING ISO 7388-2B

Tirante con agujero pasante y junta tórica ISO 7388-2B

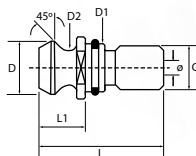

Cod.	ISO	G	D	D1	D2	ø	L	L1	Kg	Price €
93470.43843	BT 40	M16	18,9	17	12,9	7,3	44,5	16,4	0,15	
93470.43844	BT 50	M24	29,1	25	19,6	11,5	65,5	25,5	0,20	

ACCESSORIES

PULL STUD MAS/BT DRILLED WITH O-RING

Tirante MAS/BT con agujero pasante y junta tórica

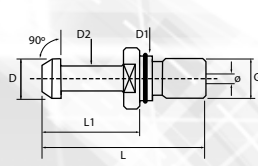
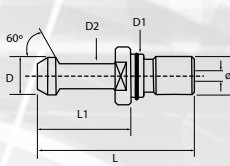
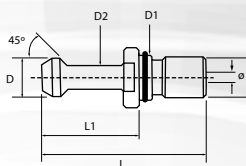

Cod.	ISO	G	α	D	D1	D2	ø	L	L1	Kg	Price €
93470.44428	BT 40	M16	60°	23	15	10	4	60	35	0,1	
93470.44429	BT 40	M16	45°	23	15	10	4	60	35	0,1	
93470.44420	BT 40	M16	90°	23	15	10	4	60	35	0,1	
93470.44421	BT 50	M24	60°	38	23	17	6	85	45	0,1	
93470.44432	BT 50	M24	45°	38	23	17	6	85	45	0,1	
93470.44433	BT 50	M24	90°	38	23	17	6	85	45	0,1	

ACCESSORIES

PULL STUD DRILLED WITH O-RING ISO 7388-2A

Tirante con agujero pasante y junta tórica ISO 7388-2A

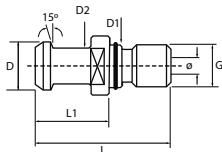

Cod.	ISO	G	α	D	D1	D2	ϕ	L	L1	Kg	Price €
93470.43845	BT 40	M16	15°	19	17	14	7	54	26	0,15	
93470.43846	BT 50	M24	15°	28	25	21	11,5	74	34	0,23	

ACCESSORIES

PULL STUD OTT DRILLED WITH INTERNAL THREAD DIN 2080

Tirante OTT con agujero pasante y rosca interior DIN 2080

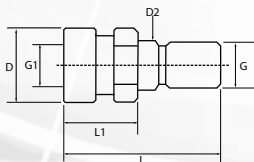

Cod.	ISO	G	G1	D	D2	L	L1	Kg	Price €
93470-44247	SK 40	M16	M16	25,3	17	53	25	0,1	
93470-44246	SK 50	M24	M24	39,6	25	65	25	0,22	
93470-44262	BT 40	M16	M16	25,3	17	56	28	0,1	

ACCESSORIES

WRENCH FOR ER COLLET CHUCKS

Llave para portapinzas ER



ER
System

Cod.	Type ER	Kg	Price €
93660-425222	ER 16	0,6	
93660-425223	ER 25	0,7	
93660-425224	ER 32	0,8	
93660-425225	ER 40	1,0	

ACCESSORIES

CLAMPING NUT FOR ER COLLET CHUCKS

Tuercas para portapinzas ER



ER
System

Cod.	Type ER	D	M	Kg	Price €
93620.425227	ER 16	32	M-22x1.50	0,20	
93620.425223	ER 25	42	M-32x1.50	0,30	
93620.425224	ER 32	50	M-40x1.50	0,35	
93620.425225	ER 40	63	M-50x1.50	0,45	

TECHNICAL INFORMATION

Material

- Case -hardened and tempered alloy steel
- Surface hardness 58-60 HRC
- Minimum strength in core 900 N/mm²
- Taper tolerance
- Grade AT3

Material

- Acero aleado de cementación, cementado y templado
- Dureza superficial 58-60 HRC
- Resistencia mínima al núcleo 900 N/mm²
- Tolerancia cono
- Grado AT3

SK STANDARD DIN 69871

For tool shanks SK in accordance with ISO 7388-1

Form AD

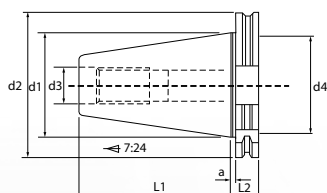

Form AD+B

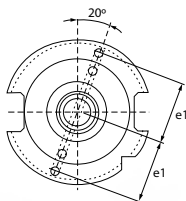

Dimensions in mm

	a +/-0.1	d1	d2+/-0.1	d3	d4 max.	e1 +/-0.1	L1 0/-0.3	L2 0/-0.1
	AD+B							
SK40	3,2	44,45	63,55	M-16	50	27	68,4	19,1
SK50	3,2	69,85	97,5	M-24	80	42	101,75	19,1

BT STANDARD JIS BT 6339

For tool shanks BT in accordance with ISO 7388-2

Form AD

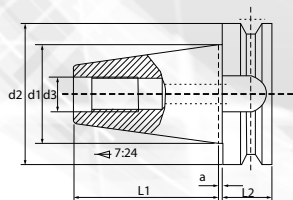

Form AD+B

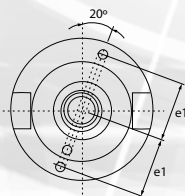

Dimensions in mm

	a +/-0.4	d1	d2 h8	d3	e1 +/-0.1	L1 +/-0.2	L2 0/-0.1
	AD+B						
BT40	2	44,45	63	M-16	27	65,4	27
BT50	3	68,95	100	M-24	42	101,8	38