

		PAGINA Page Seite
<p>MODULO MOTORIZZATO ASSIALE 3 USCITE Axial multiple 3 outlet driven tool Axial angetriebenes Mehrspindel-Werkzeug 3 Ausgaenge</p>		NOM265.1.10
<p>MODULO MOTORIZZATO ASSIALE 4 USCITE MOLTIPLICATO I=1:2 Axial geared-up I=1:2 multiple 4 outlet driven tool Axial angetriebenes Mehrspindel-Werkzeug 4 Ausgaenge uebersetzt I=1:2</p>		NOM271.1.00
<p>MODULO MOTORIZZATO ORIENTABILE ±90° ±90° adjustable angle driven tool Angetriebenes Werkzeug schwenkbar ±90°</p>		NOM335.1.00
<p>MODULO MOTORIZZATO ORIENTABILE DOPPIO ±90° ±90° double adjustable angle driven tool Doppel-Angetriebenes Werkzeug schwenkbar ±90°</p>		NOM338.1.00
<p>MODULO MOTORIZZATO ORIENTABILE DOPPIO ±90° PER CONTROMANDRINO ±90° double adjustable angle driven tool for subspindle Doppel-Angetriebenes Werkzeug schwenkbar ±90° fuer Gegenspindle</p>		NOM338.1.10
<p>MODULO MOTORIZZATO ORIENTABILE TRIPLO ±90° ±90° triple adjustable angle driven tool Dreifach-Angetriebenes Werkzeug schwenkbar ±90°</p>		NOM338.1.20
<p>MODULO MOTORIZZATO PORTACREATORE Driven gear hobber Angetriebenes Zahnradwaelzfraes-Werkzeug</p>		NOM340.1.00
<p>MODULO MOTORIZZATO TURBINATORE RIDOTTO I=2:1 Driven whirling tool geared-down I=2:1 Gewindewirbeleinrichtung untersetzt I=2:1</p>		NOM370.1.00

		PAGINA Page Seite
<p>MODULO MOTORIZZ. ORIENTABILE DOPPIO <math>\pm 90^\circ</math>  <math>\pm 90^\circ</math> double adjustable angle driven tool                      Doppel-Angetriebenes Werkzeug schwenkbar <math>\pm 90^\circ</math></p>		NOM338.2.00
<p>MODULO MOTORIZZATO PORTACREATORE                      Driven gear hobber                      Angetriebenes Zahnradwaelzfraes-Werkzeug</p>		NOM340.2.00
<p>MODULO MOTORIZZATO TURBINATORE RIDOTTO I=2:1                      Driven whirling tool geared-down I=2:1                      Gewindewirbeleinrichtung untersetzt I=2:1</p>		NOM370.2.00

		PAGINA Page Seite
<p>MODULO MOTORIZZATO ASSIALE 3 USCITE Axial multiple 3 outlet driven tool Axial angetriebenes Mehrspindel-Werkzeug 3 Ausgaenge</p>		NOM265.3.10
<p>MODULO MOTORIZZATO ASSIALE 4 USCITE MOLTIPLICATO I=1:2 Axial geared-up I=1:2 multiple 4 outlet driven tool Axial angetriebenes Mehrspindel-Werkzeug 4 Ausgaenge uebersetzt I=1:2</p>		NOM271.3.00
<p>MODULO MOTORIZZ. ORIENTABILE DOPPIO ±90° ±90° double adjustable angle driven tool Doppel-Angetriebenes Werkzeug schwenkbar ±90°</p>		NOM338.3.00

		PAGINA Page Seite
MODULO MOTORIZZATO ASSIALE ORIENTABILE 0/90° 0/90° axial adjustable angle driven tool Axial angetriebenes Werkzeug schwenkbar 0/90°		NOM183.4.10

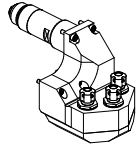
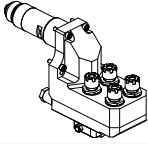
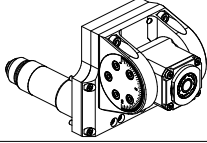
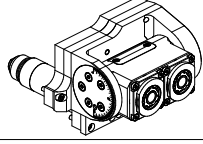
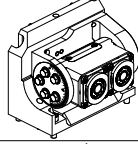
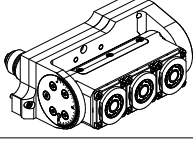
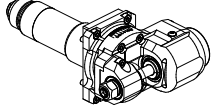
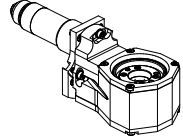
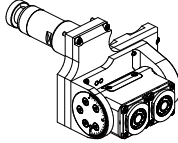
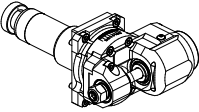
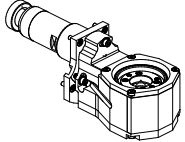
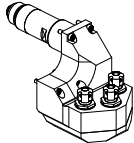
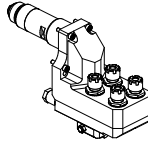
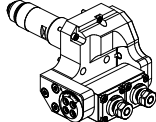
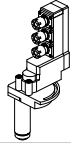
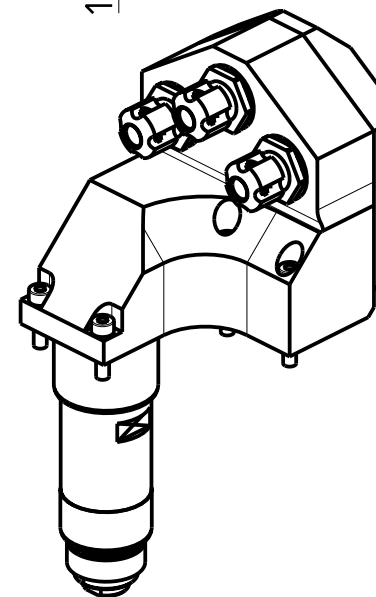
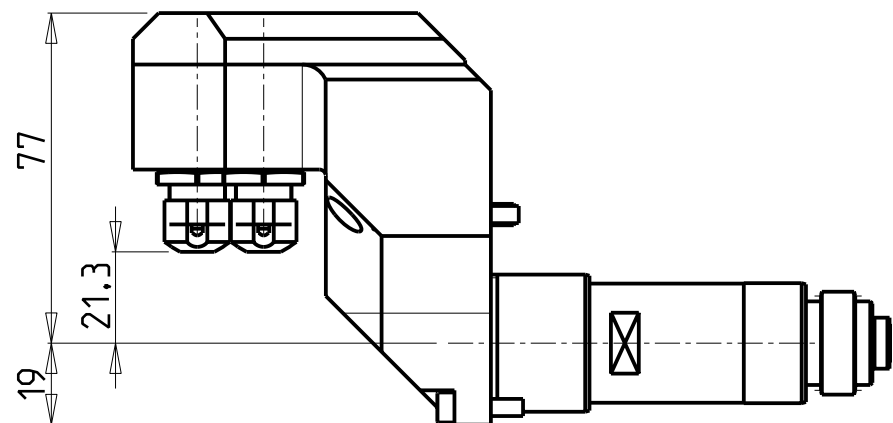
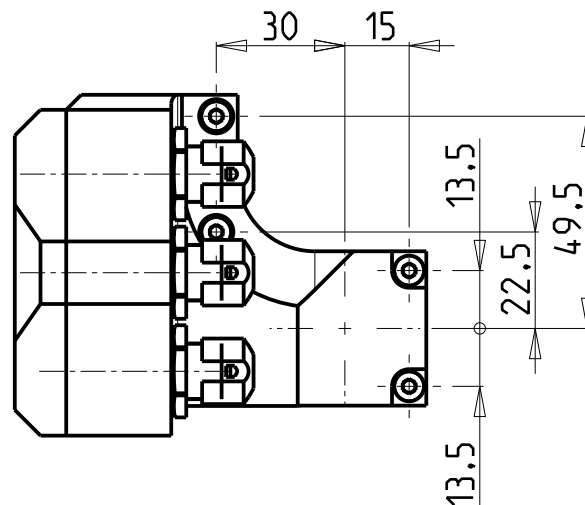
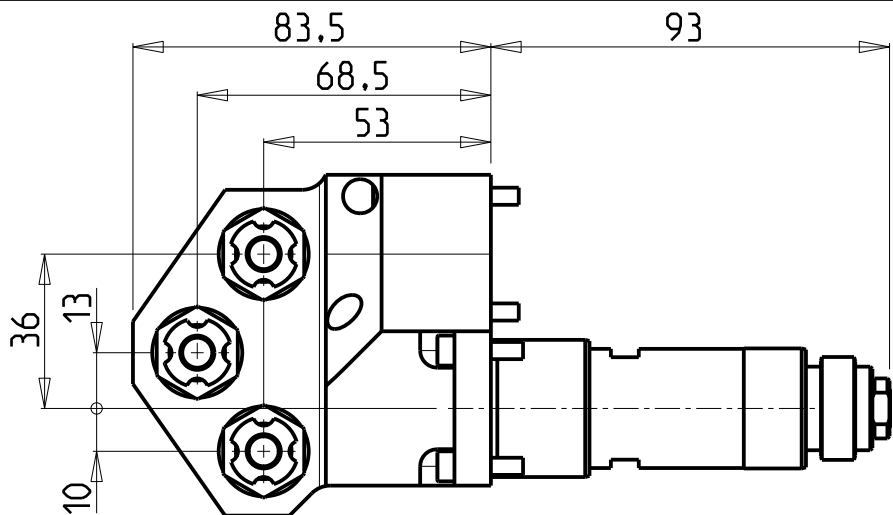

T16

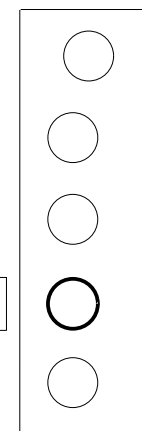

**ATTENZIONE - ATTENTION - ACHTUNG**

- Per lo smontaggio degli utensili utilizzare sempre la chiave di contrasto come indicato nel manuale d'uso.
- For disassembly of the tools use always the contrast key as mentioned in the user instructions.
- Fuer das Abmontieren der Werkzeuge immer den Gegenschlüssel benutzen wie in der Bedienungsanleitung erwäehnt.

Cod. MT	Mandrino Spindle Spindel	I	RPM	N°Utensili N°Tools N°Werkzeuge	Lubr.esterna Ext. coolant Aussenkehlung	CHIAVI NON INCLUSE Keys not included Schluessel nicht einbegriffen	
SPC0991000	ER11	1:1	6000	3	X	CHMNER11	CHUB19_SP3

NOMURA  
MOD: NN20J - NN20J2 - NN20JS

MODULO MOTORIZZATO ASSIALE 3 USCITE  
Axial multiple 3 outlet driven tool  
Axial angetriebenes Mehrspindel-Werkzeug 3 Ausgaenge

Subject to change without notice.

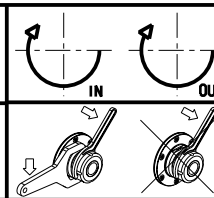

**M.T. srl**  
Via Casino Albini 480  
Tel. 0541/956034-957884  
Fax 0541/956341  
47842 S. GIOVANNI IN M. (RN)  
e-mail: mtma@mtmarchetti.com  
http://www.mtmarchetti.com



PAGINA NOM265-1-10

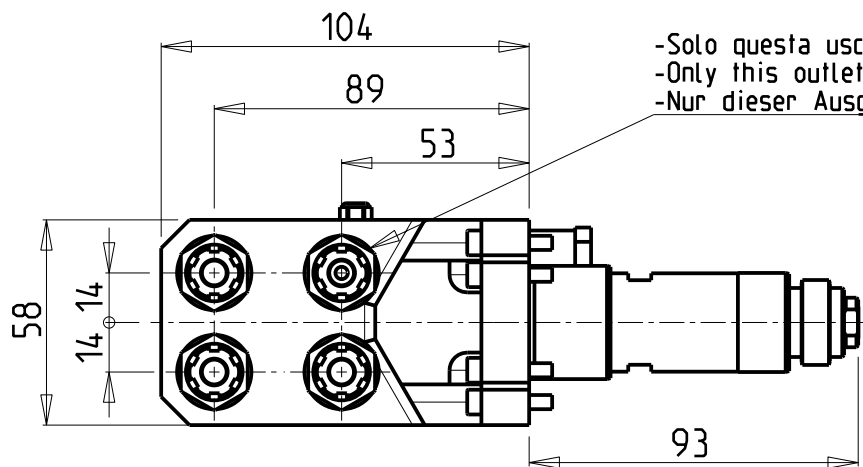

-Solo questa uscita è con lubrificazione interna.  
 -Only this outlet is with internal coolant.  
 -Nur dieser Ausgang ist mit IKZ.

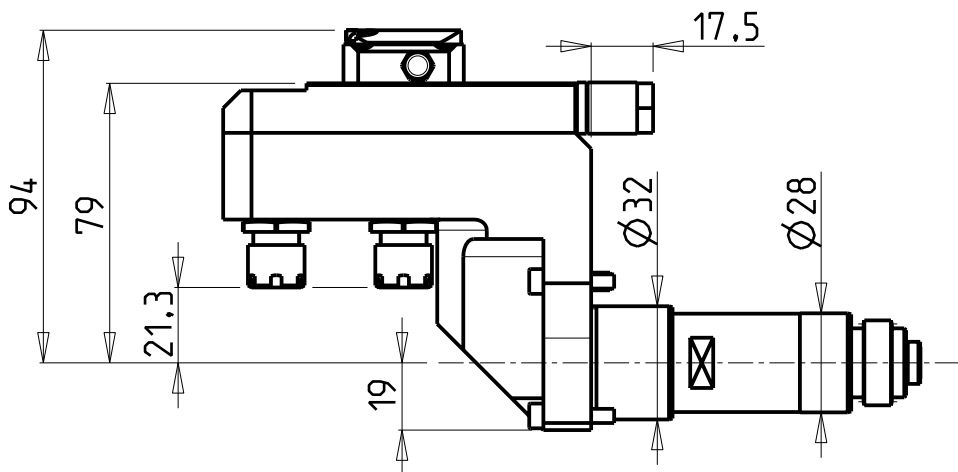
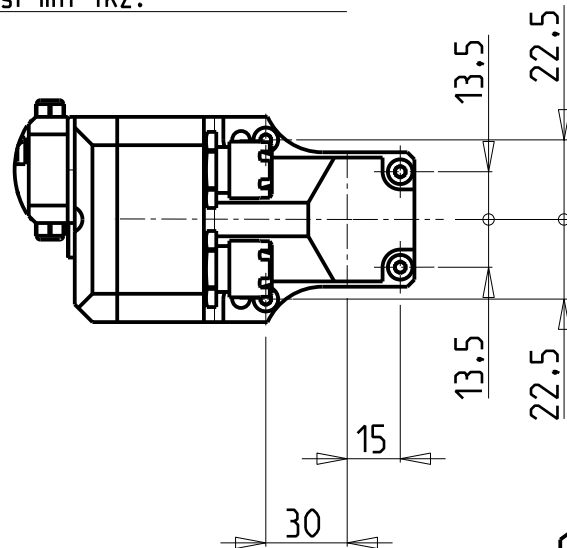

**ATTENZIONE - ATTENTION - ACHTUNG**

- Per lo smontaggio degli utensili utilizzare sempre la chiave di contrasto come indicato nel manuale d'uso.
- For disassembly of the tools use always the contrast key as mentioned in the user instructions.
- Fuer das Abmontieren der Werkzeuge immer den Gegenschlüssel benutzen wie in der Bedienungsanleitung erwaeht.

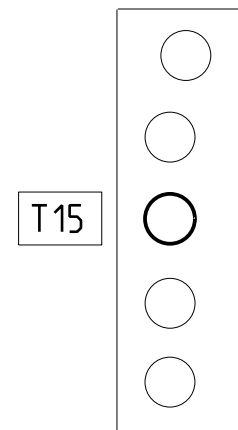
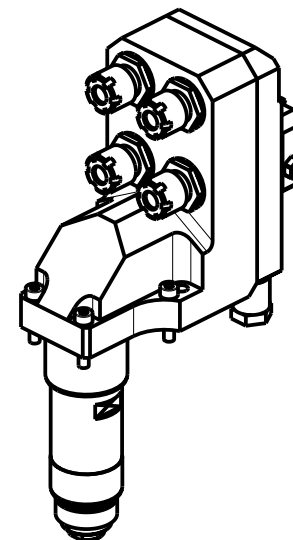

T15

Cod. MT	Mandrino Spindle Spindel	I	RPM	N°Utensili N°Tools N°Werkzeuge	Lubrificazione int. Coolant through Innenkuehlung	Lubr.esterna Ext. coolant Aussenkuehlung	CHIAVI NON INCLUDE Keys not included Schluessel nicht einbegriffen	
NMR0100111	ER11	1:2	12000	4	P=25bar	X	CHMNER11	CHUB19_SP3

NOMURA  
 MOD: NN20J - NN20J2 - NN20JS

MODULO MOTORIZZATO ASSIALE 4 USCITE MOLTIPLICATO I=1:2  
 Axial geared-up I=1:2 multiple 4 outlet driven tool  
 Axial angetriebenes Mehrspindel-Werkzeug 4 Ausgaenge uebersetzt I=1:2

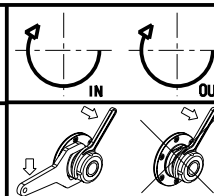

**M.T. srl**  
 Via Casino Albini 480  
 Tel. 0541/956034-957884  
 Fax 0541/956341  
 47842 S. GIOVANNI IN M. (RN)  
 e-mail: mtma@mtmarchetti.com  
 http://www.mtmarchetti.com



PAGINA NOM271-1-00

Subject to change without notice.

10/2021

**ATTENZIONE - ATTENTION - ACHTUNG**

- Per lo smontaggio degli utensili utilizzare sempre la chiave di contrasto come indicato nel manuale d'uso.
- For disassembly of the tools use always the contrast key as mentioned in the user instructions.
- Fuer das Abmontieren der Werkzeuge immer den Gegenschlüssel benutzen wie in der Bedienungsanleitung erwaeht.

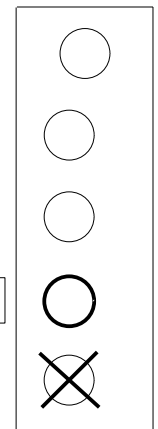
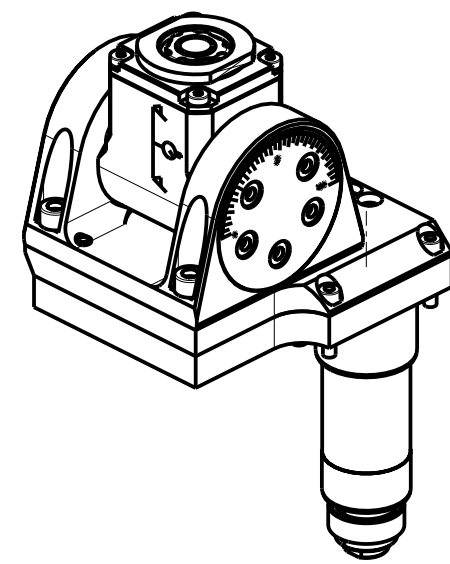
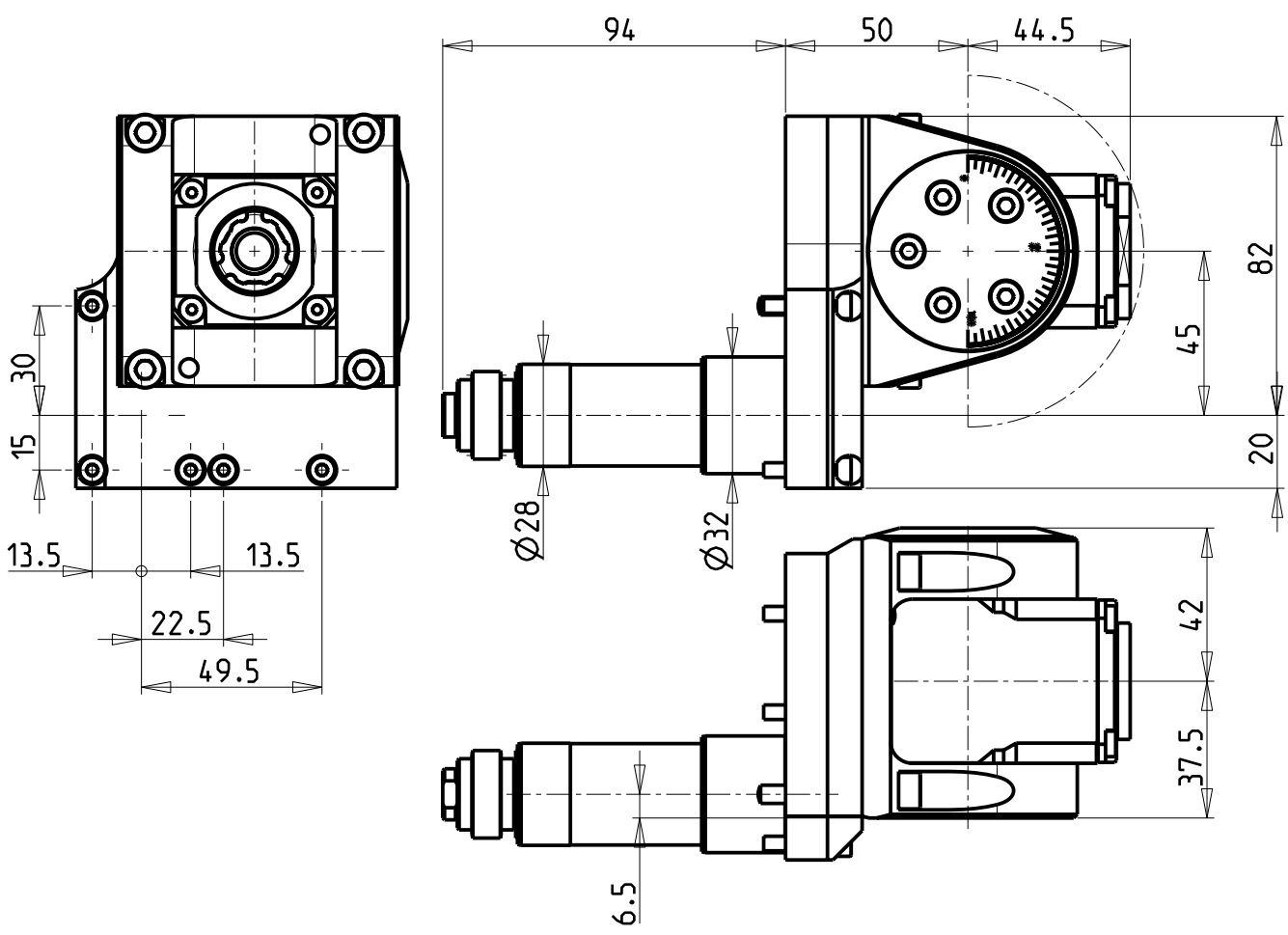

T16

Cod. MT	Mandrino Spindle Spindel	I	RPM	Lubrificazione est. Ext. coolant Aussenkuehlung	CHIAVI INCLUSE Keys included Schlüssel inbegriffen		
SPC0801000	ERA16	1:1	6000	X	CHUB32	CHUB19_SP3	CHTAER16ZC

NOMURA  
MOD: NN20J - NN20J2 - NN20JS

MODULO MOTORIZZATO ORIENTABILE ±90°  
±90° adjustable angle driven tool  
Angetriebenes Werkzeug schwenkbar ±90°

Subject to change without notice.

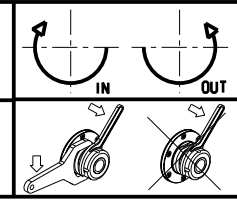

**M.T. srl**  
Via Casino Albini 480  
Tel. 0541/956034-957884  
Fax 0541/956341  
47842 S. GIOVANNI IN M. (RN)  
e-mail: mtma@mtmarchetti.com  
http://www.mtmarchetti.com



PAGINA NOM335-1-00

**ATTENZIONE - ATTENTION - ACHTUNG**

- Per lo smontaggio degli utensili utilizzare sempre la chiave di contrasto come indicato nel manuale d'uso.
- For disassembly of the tools use always the contrast key as mentioned in the user instructions.
- Fuer das Abmontieren der Werkzeuge immer den Gegenschlüssel benutzen wie in der Bedienungsanleitung erwaeht.

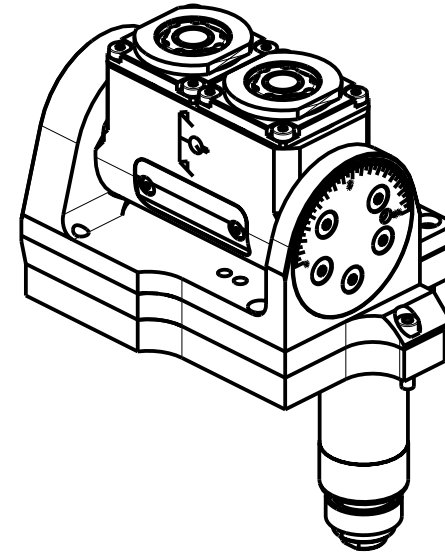
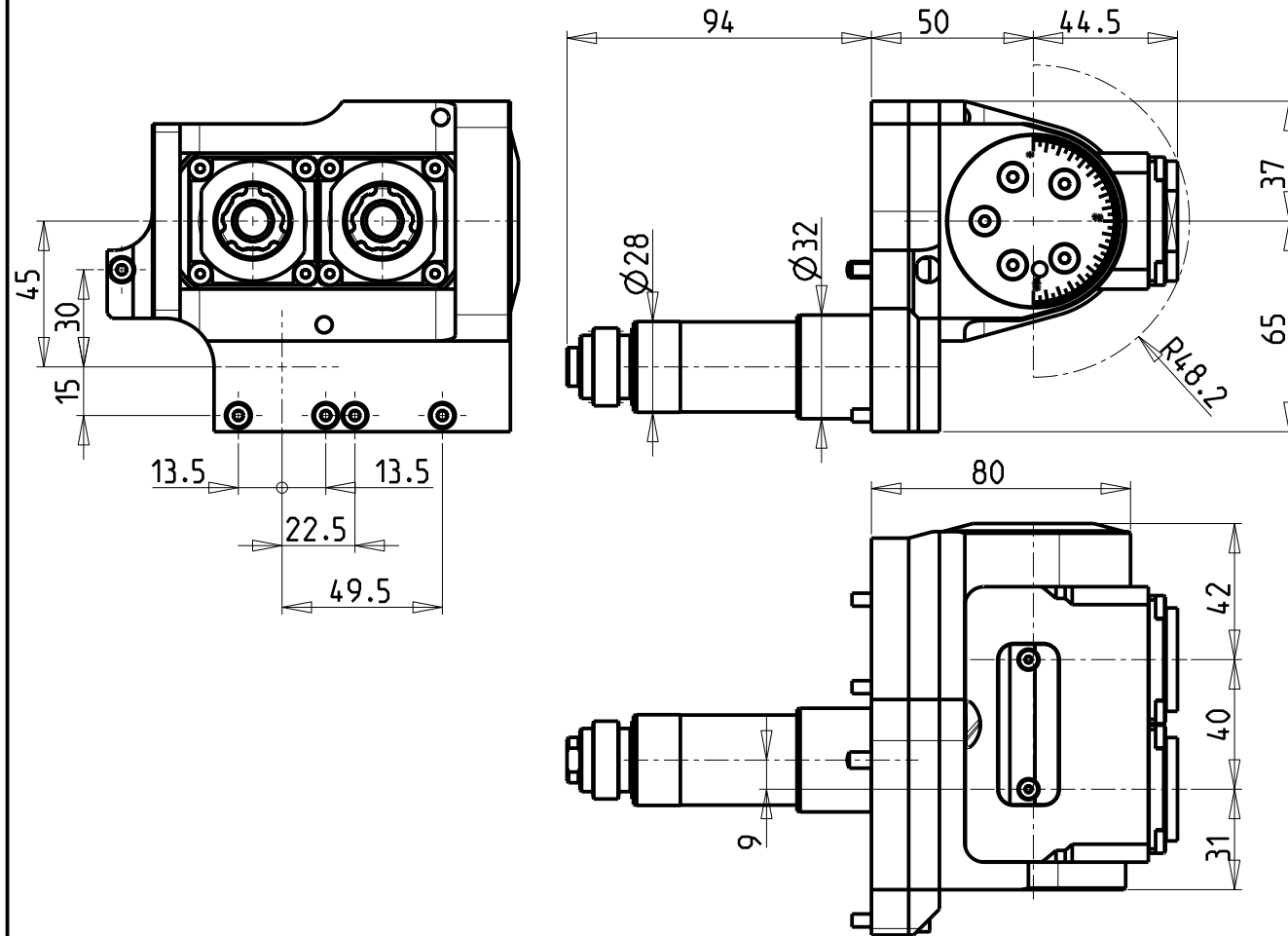

T16

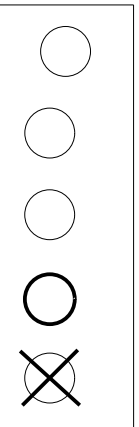

Cod. MT	Mandrino Spindle Spindel	I	RPM	Lubrificazione est. Ext. coolant Aussenkuehlung	CHIAVI INCLUSE Keys included Schlüssel inbegriffen		
SPC0951000	ERA16	1:1	6000	X	CHUB32	CHUB19_SP3	CHTAER16ZC

NOMURA  
MOD: NN20J - NN20J2 - NN20JS

MODULO MOTORIZZATO ORIENTABILE DOPPIO ±90°  
±90° double adjustable angle driven tool  
Doppel-Angetriebenes Werkzeug schwenkbar ±90°

Subject to change without notice.

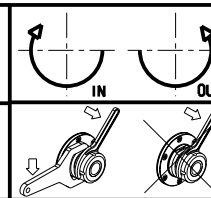

**M.T. srl**  
Via Casino Albini 480  
Tel. 0541/956034-957884  
Fax 0541/956341  
47842 S. GIOVANNI IN M. (RN)  
e-mail: mtma@mtmarchetti.com  
http://www.mtmarchetti.com



PAGINA NOM338-1-00



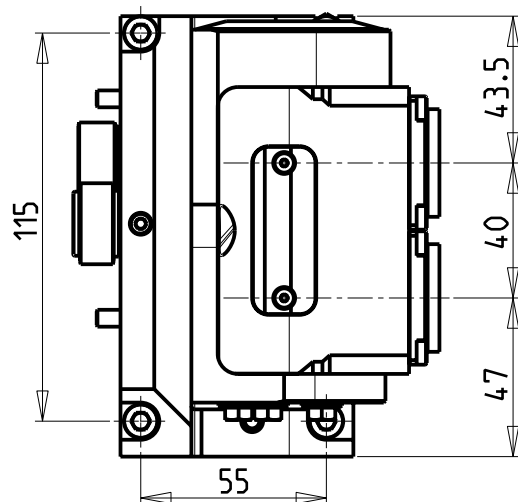
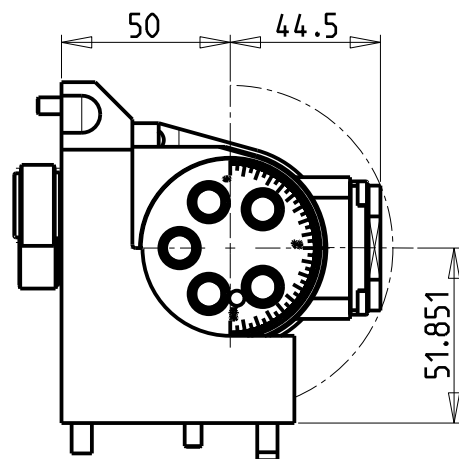
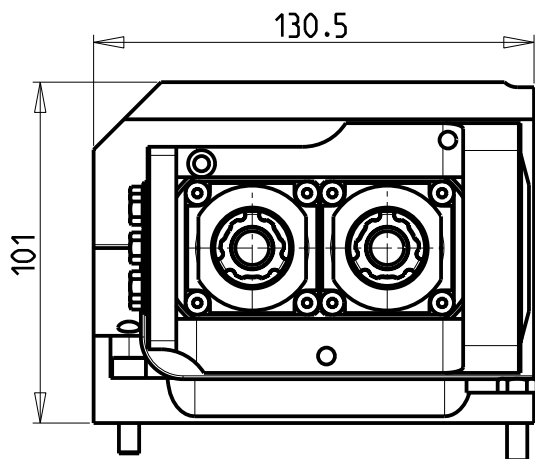

**ATTENZIONE - ATTENTION - ACHTUNG**

- Per lo smontaggio degli utensili utilizzare sempre la chiave di contrasto come indicato nel manuale d'uso.
- For disassembly of the tools use always the contrast key as mentioned in the user instructions.
- Fuer das Abmontieren der Werkzeuge immer den Gegenschuessel benutzen wie in der Bedienungsanleitung erwaeht.

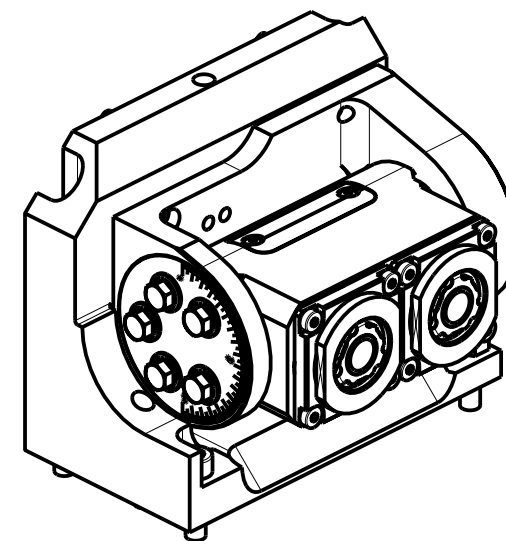

Cod. MT	Mandrino Spindle Spindel	I	RPM	Lubrificazione est. Ext. coolant Aussenkuehlung	CHIAVI INCLUSE Keys included Schuessel inbegriffen			
NMR0020216	ERA16	1:1	6000	X	CHUB32	CHUB19_SP3	CHTAER16ZC	CH_POLIG_08

NOMURA  
MOD: NN20J - NN20J2 - NN20JS

MODULO MOTORIZZATO ORIENTABILE DOPPIO ±90° PER CONTROMANDRINO  
±90° double adjustable angle driven tool for subspindle  
Doppel-Angetriebenes Werkzeug schwenkbar ±90° fuer Gegenspindel

Subject to change without notice.

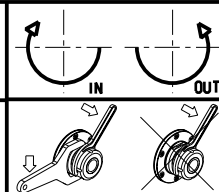

**M.T. srl**  
Via Casino Albini 480  
Tel. 0541/956034-957884  
Fax 0541/956341  
47842 S. GIOVANNI IN M. (RN)  
e-mail: mtma@mtmarchetti.com  
http://www.mtmarchetti.com



PAGINA NOM338-1-10

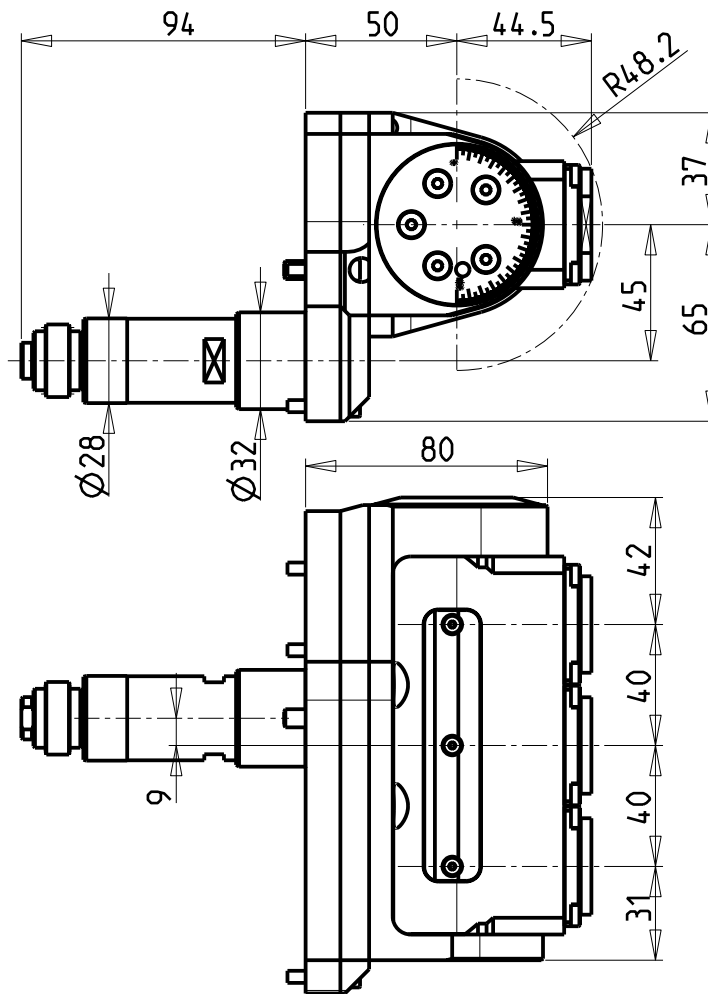
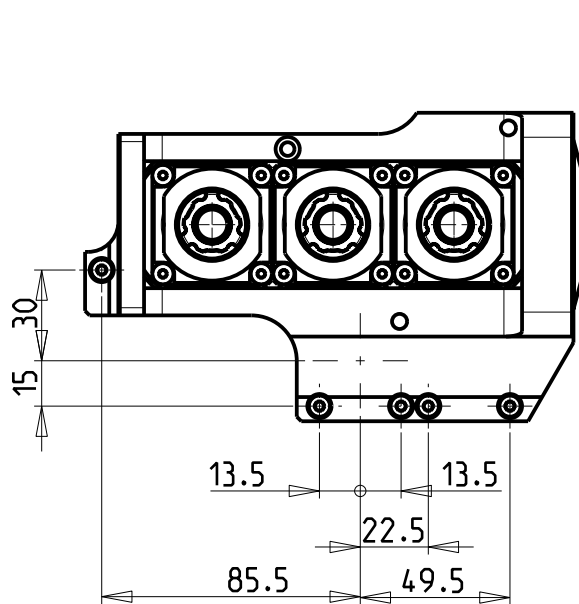

**ATTENZIONE - ATTENTION - ACHTUNG**

- Per lo smontaggio degli utensili utilizzare sempre la chiave di contrasto come indicato nel manuale d'uso.
- For disassembly of the tools use always the contrast key as mentioned in the user instructions.
- Fuer das Abmontieren der Werkzeuge immer den Gegenschlüssel benutzen wie in der Bedienungsanleitung erwaeht.

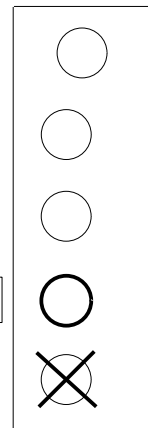
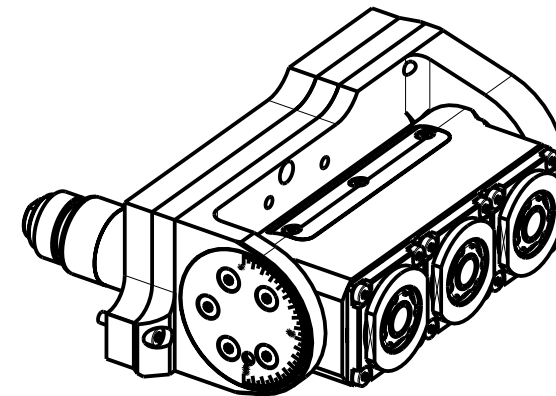

T16

Cod. MT	Mandrino Spindle Spindel	I	RPM	Lubrificazione est. Ext. coolant Aussenkuehlung	CHIAVI INCLUSE Keys included Schluesssel inbegriffen		
NMR0040316	ERA16	1:1	6000	X	NMR0040012	CHUB19_SP3	CHTAER16ZC

NOMURA  
MOD: NN20J - NN20J2 - NN20JS

MODULO MOTORIZZATO ORIENTABILE TRIPLO ±90°  
±90° triple adjustable angle driven tool  
Dreifach-Angetriebenes Werkzeug schwenkbar ±90°

Subject to change without notice.

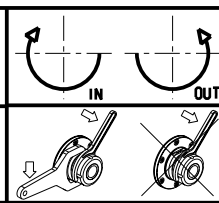

**M.T. srl**  
Via Casino Albini 480  
Tel. 0541/956034-957884  
Fax 0541/956341  
47842 S. GIOVANNI IN M. (RN)  
e-mail: mtma@mtmarchetti.com  
http://www.mtmarchetti.com



PAGINA NOM338-1-20

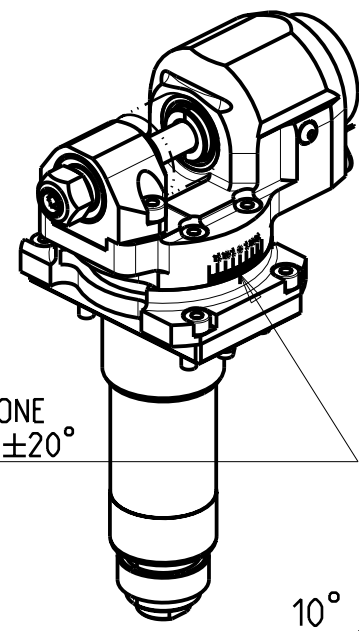
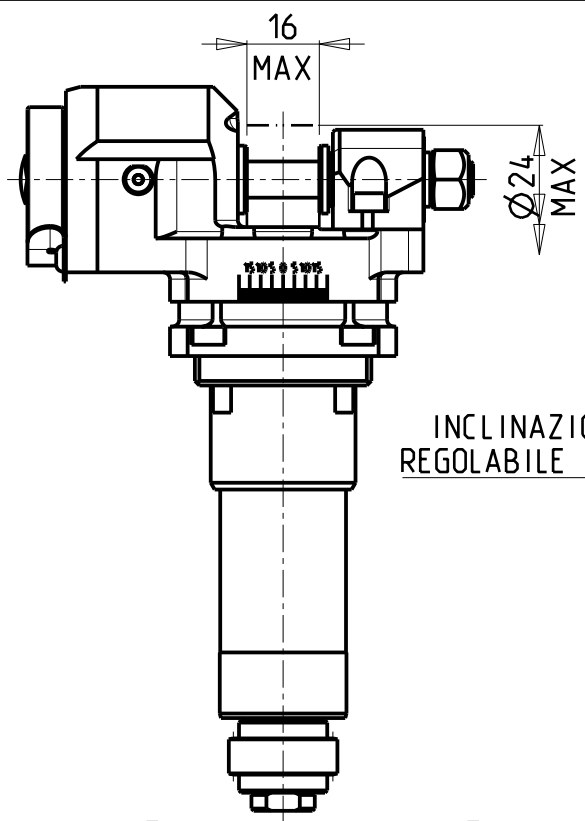
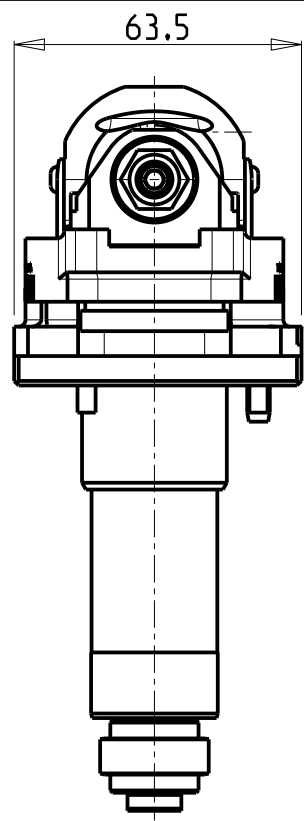
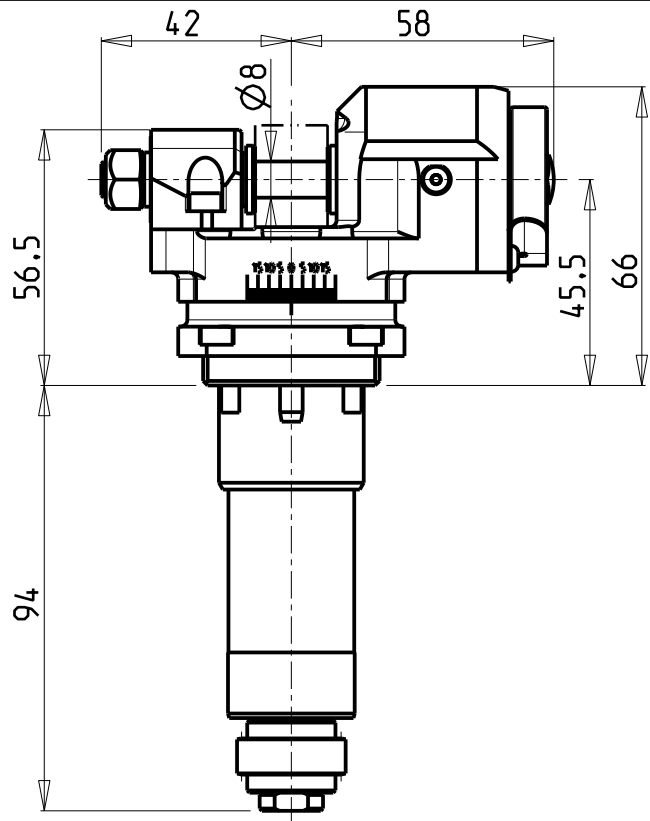

INCLINAZIONE  
REGOLABILE  $\pm 20^\circ$

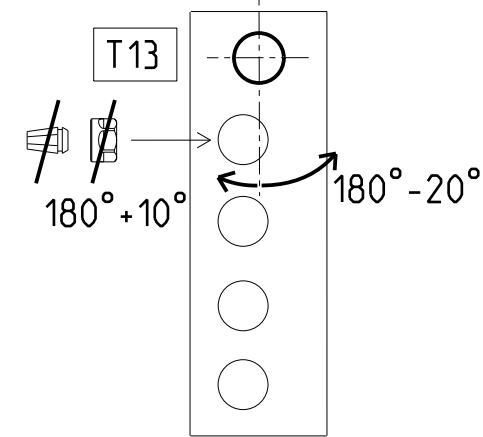
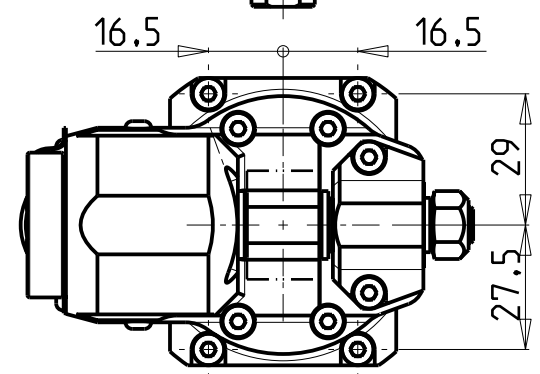
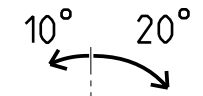

Cod. MT	I	RPM max	Lubrificazione est. Ext. coolant Aussenkuehlung	CHIAVI INCLUDE Keys included Schluessel inbegriffen
SPC0971000	1:1	6000	X	CHESL04 CHUB13

NOMURA  
MOD: NN20J - NN20J2 - NN20JS  
MODULO MOTORIZZATO PORTACREATORE  
Driven gear hobber  
Angetriebenes Zahnradwaeltzraes-Werkzeug

Subject to change without notice.

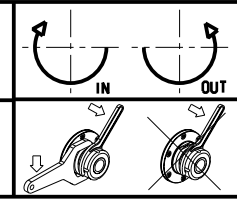

**M.T. srl**  
Via Casino Albini 480  
Tel. 0541/956034-957884  
Fax 0541/956341  
47842 S. GIOVANNI IN M. (RN)  
e-mail: mtma@mtmarchetti.com  
http://www.mtmarchetti.com



PAGINA NOM340-1-00

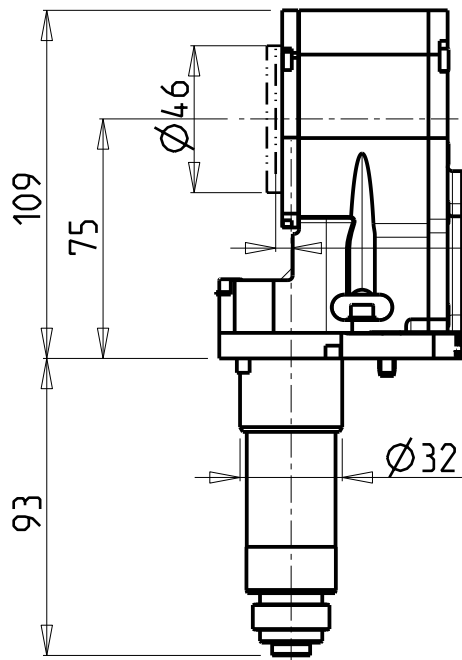
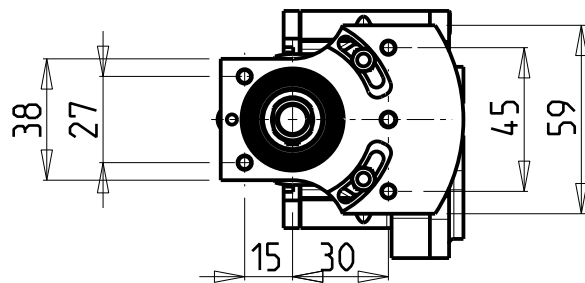

4  
 Piano Inserti  
 Inserts Surface  
 Einsaetze Flaechе

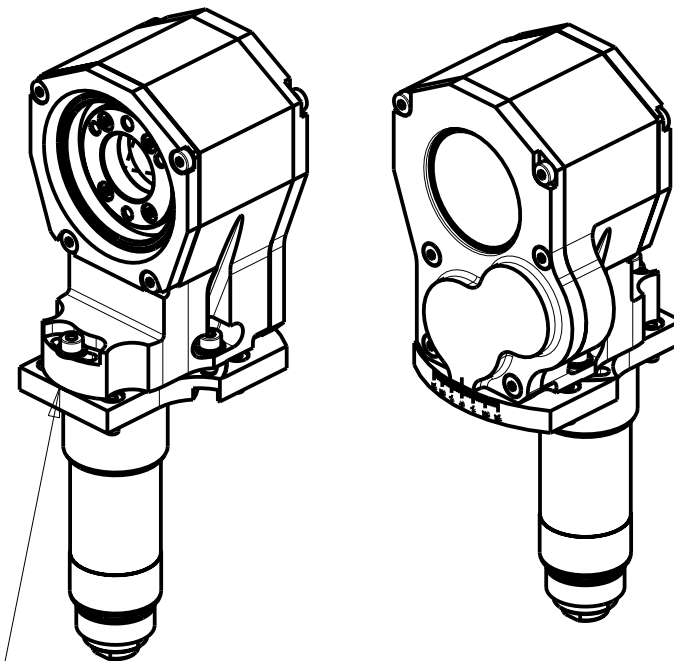
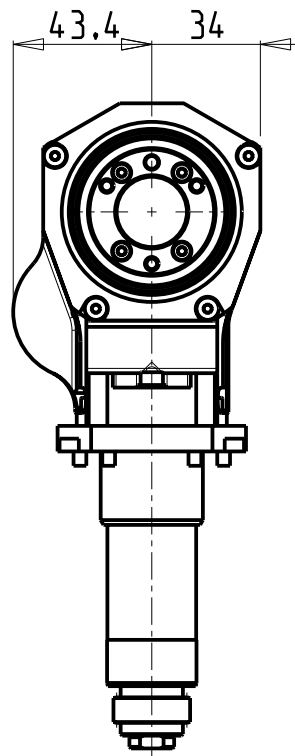

INCLINAZIONE  
 REGOLABILE ±15°

T15

T16

T17

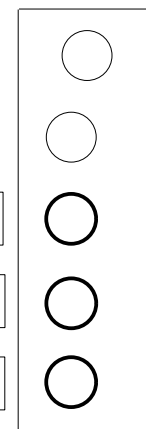

Cod. MT	I	RPM	Lubrificazione est. Ext. coolant Aussenkuehlung
NMR0010112	2:1	3000	X

Fresa non inclusa:  
 Milling-cutter not included:  
 Fraese nicht inbegriffen:  
 SANDVIK Coromill 325 cod. 325-12AP40-16M

NOMURA  
 MOD: NN20J - NN20J2 - NN20JS  
 MODULO MOTORIZZATO TURBINATORE RIDOTTO I=2:1  
 Driven whirling tool geared-down I=2:1  
 Gewindewirbeleinrichtung untersetzt I=2:1

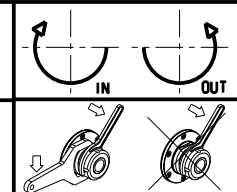

**M.T. srl**  
 Via Casino Albini 480  
 Tel. 0541/956034-957884  
 Fax 0541/956341  
 47842 S. GIOVANNI IN M. (RN)  
 e-mail: mtma@mtmarchetti.com  
 http://www.mtmarchetti.com



PAGINA NOM370-1-00

Subject to change without notice.

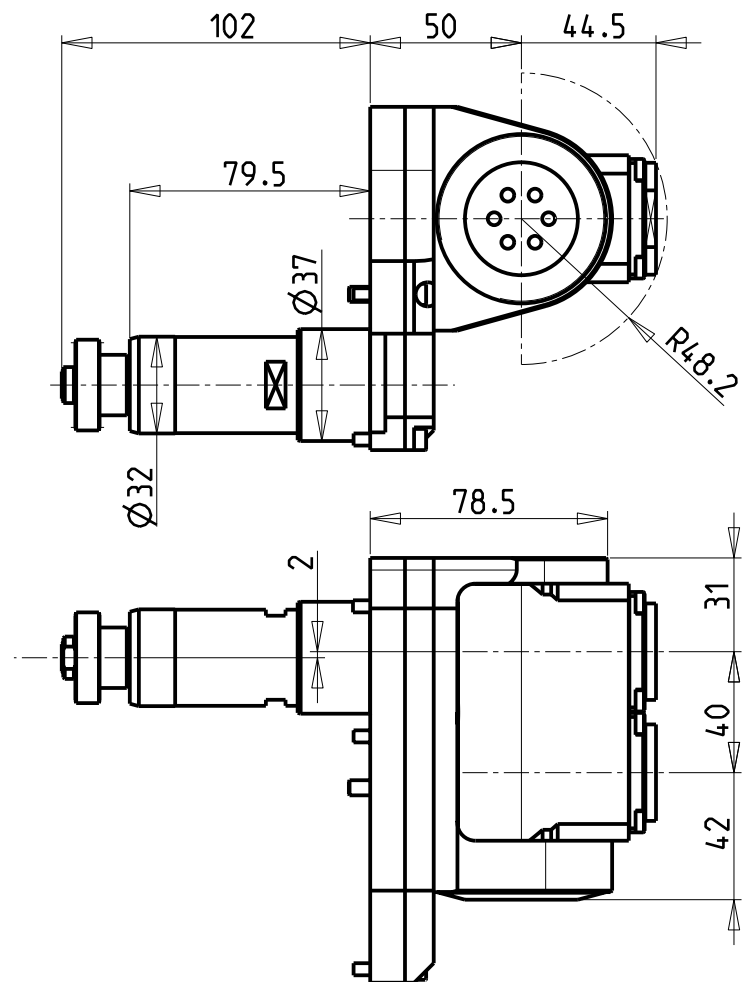
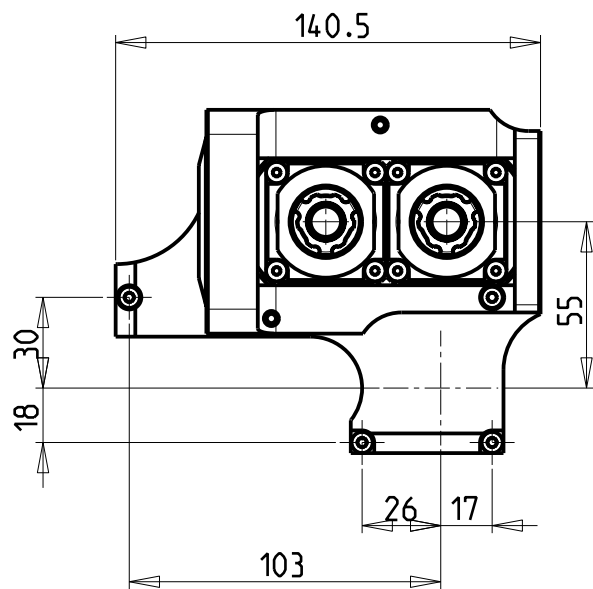

### ATTENZIONE - ATTENTION - ACHTUNG

- Per lo smontaggio degli utensili utilizzare sempre la chiave di contrasto come indicato nel manuale d'uso.
- For disassembly of the tools use always the contrast key as mentioned in the user instructions.
- Fuer das Abmontieren der Werkzeuge immer den Gegenschlüssel benutzen wie in der Bedienungsanleitung erwaeht.

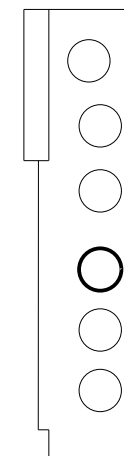
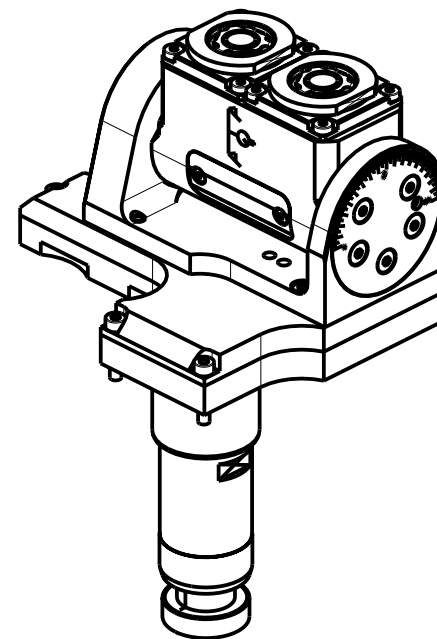

T13

Cod. MT	Mandrino Spindle Spindel	I	RPM	Lubrificazione est. Ext. coolant Aussenkuehlung	CHIAVI INCLUSE Keys included Schluesssel inbegriffen		
NMR0030216	ERA16	1:1	6000	X	CHUB32	CHUB19_SP3	CHTAER16ZC

NOMURA  
MOD: NN32YB2

MODULO MOTORIZZATO ORIENTABILE DOPPIO ±90°  
±90° double adjustable angle driven tool  
Doppel-Angetriebenes Werkzeug schwenkbar ±90°

Subject to change without notice.

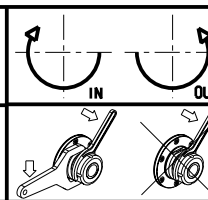

**M.T. srl**  
Via Casino Albini 480  
Tel. 0541/956034-957884  
Fax 0541/956341  
47842 S. GIOVANNI IN M. (RN)  
e-mail: mtma@mtmarchetti.com  
http://www.mtmarchetti.com



PAGINA NOM338-2-00

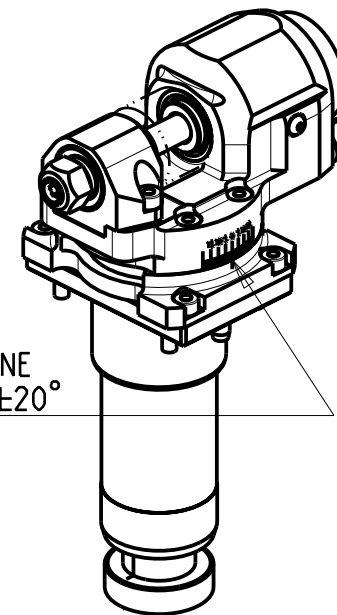
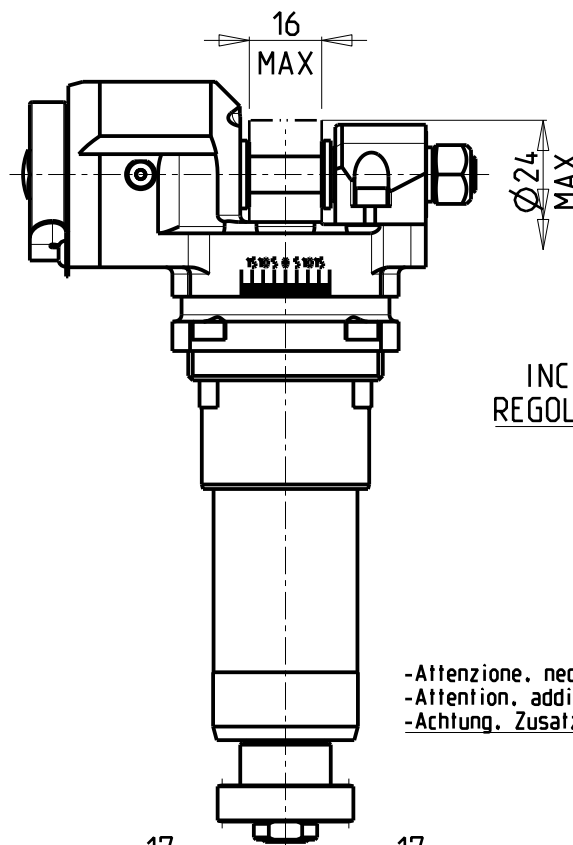
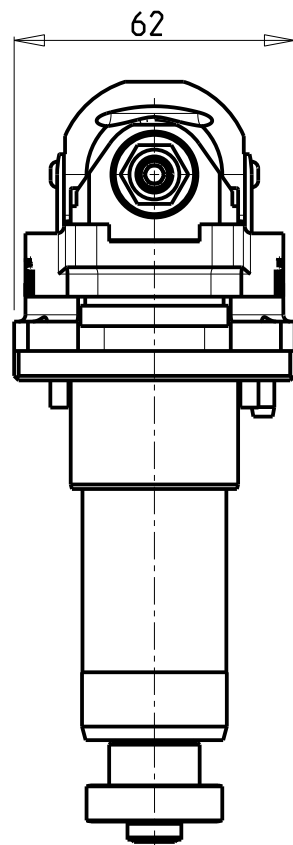
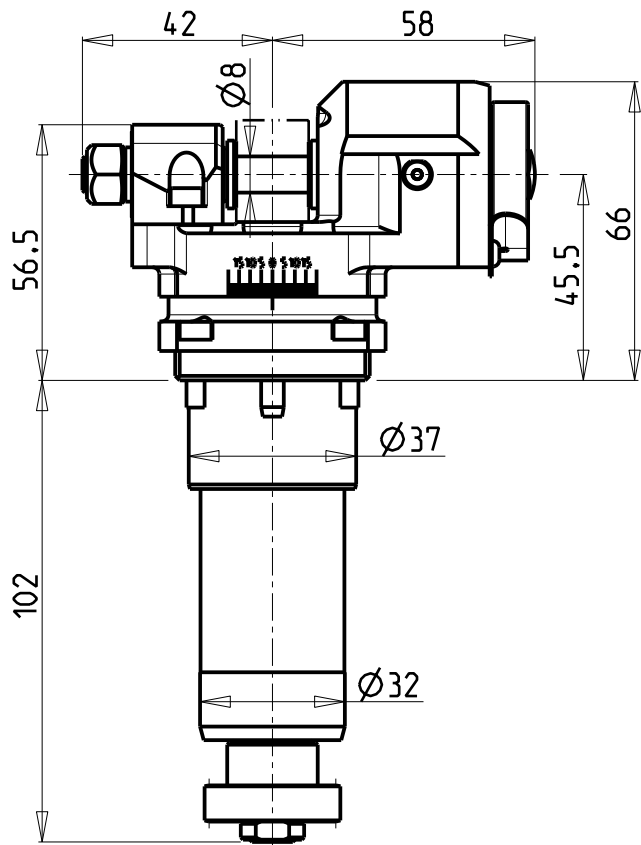

INCLINAZIONE  
REGOLABILE  $\pm 20^\circ$

-Attenzione. necessaria foratura aggiuntiva.  
-Attention. additional threads are required.  
-Achtung. Zusatzbohrung wird benoetigt.

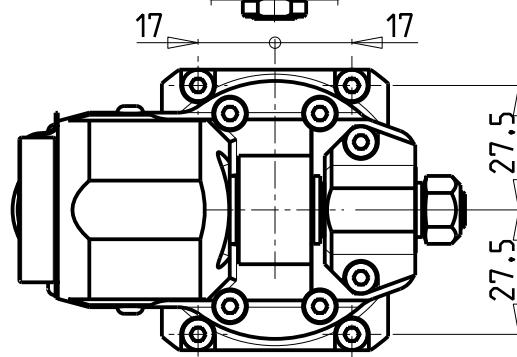
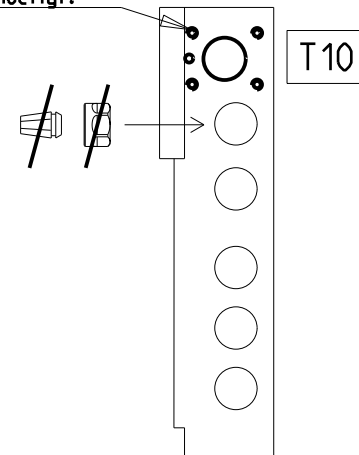

Cod. MT	I	RPM max	Lubrificazione est. Ext. coolant Aussenkuehlung	CHIAVI INCLUDE Keys included Schluessel inbegriffen	
NMR0080100	1:1	6000	X	CHESL04	CHUB13

NOMURA  
MOD: NN32YB2  
MODULO MOTORIZZATO PORTACREATORE  
Driven gear hobber  
Angetriebenes Zahnradwaeltzraes-Werkzeug

Subject to change without notice.

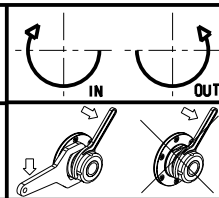

**M.T. srl**  
Via Casino Albini 480  
Tel. 0541/956034-957884  
Fax 0541/956341  
47842 S. GIOVANNI IN M. (RN)  
e-mail: mtma@mtmarchetti.com  
http://www.mtmarchetti.com



PAGINA NOM340-2-00

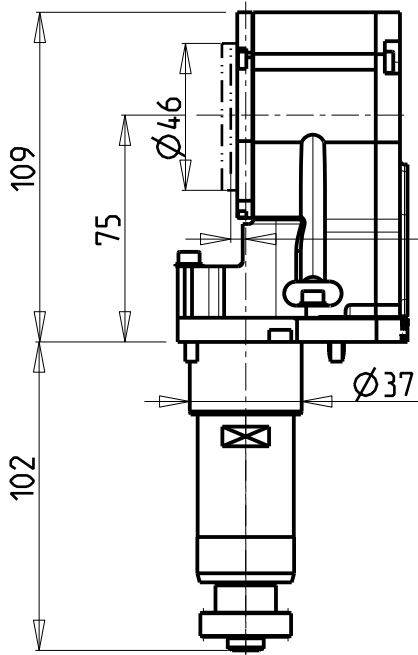
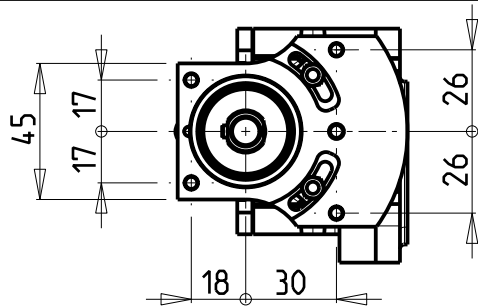

4  
Piano Inserti  
Inserts Surface  
Einsätze Fläche

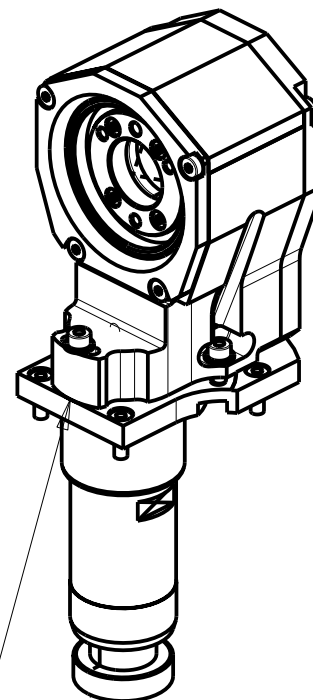
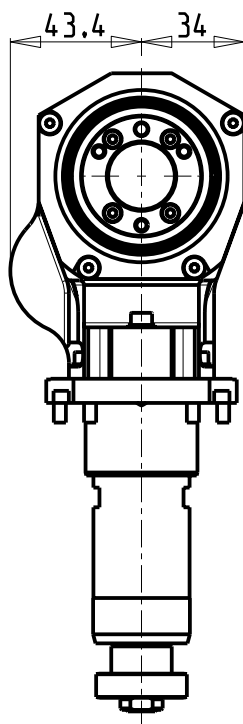

INCLINAZIONE  
REGOLABILE  $\pm 15^\circ$

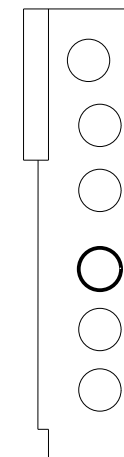
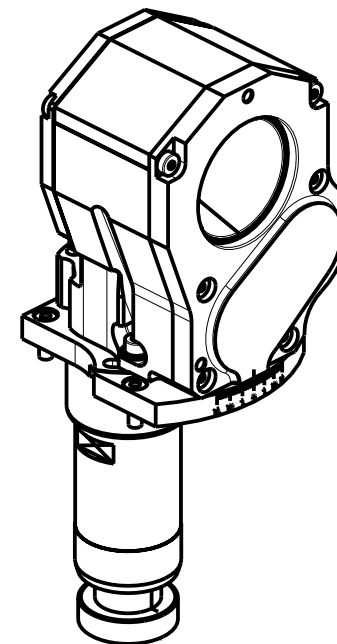

T13

Cod. MT	I	RPM	Lubrificazione est. Ext. coolant Aussenkuehlung
NMR0070112	2:1	3000	X

Fresa non inclusa:  
Milling-cutter not included:  
Fraese nicht inbegriffen:  
SANDVIK Coromill 325 cod. 325-12AP40-16M

NOMURA  
MOD: NN32YB2

MODULO MOTORIZZATO TURBINATORE RIDOTTO I=2:1  
Driven whirling tool geared-down I=2:1  
Gewindewirbeleinrichtung untersetzt I=2:1

Subject to change without notice.

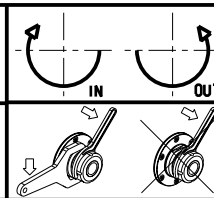

**M.T. srl**  
Via Casino Albini 480  
Tel. 0541/956034-957884  
Fax 0541/956341  
47842 S. GIOVANNI IN M. (RN)  
e-mail: mtma@mtmarchetti.com  
http://www.mtmarchetti.com



PAGINA NOM370-2-00

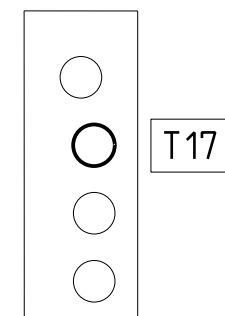
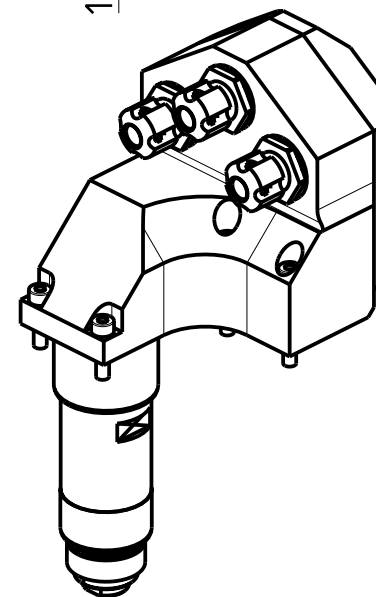
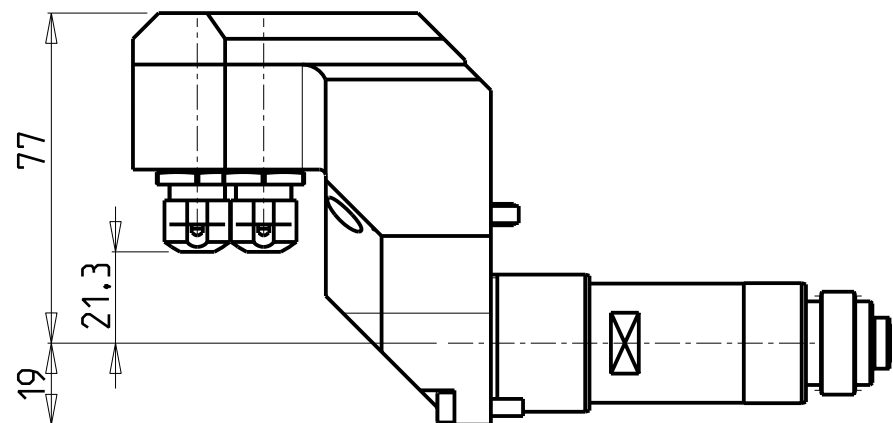
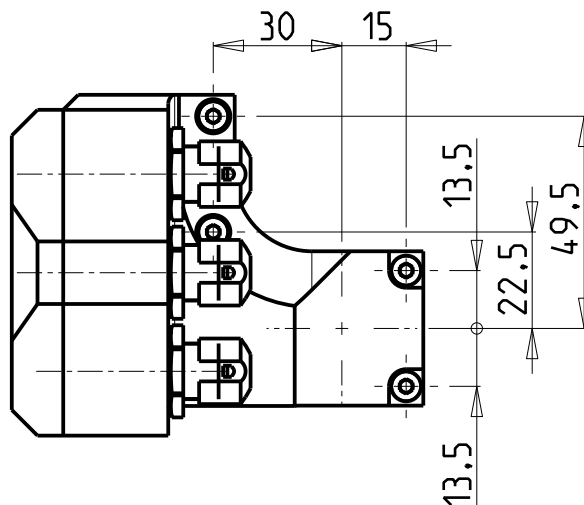
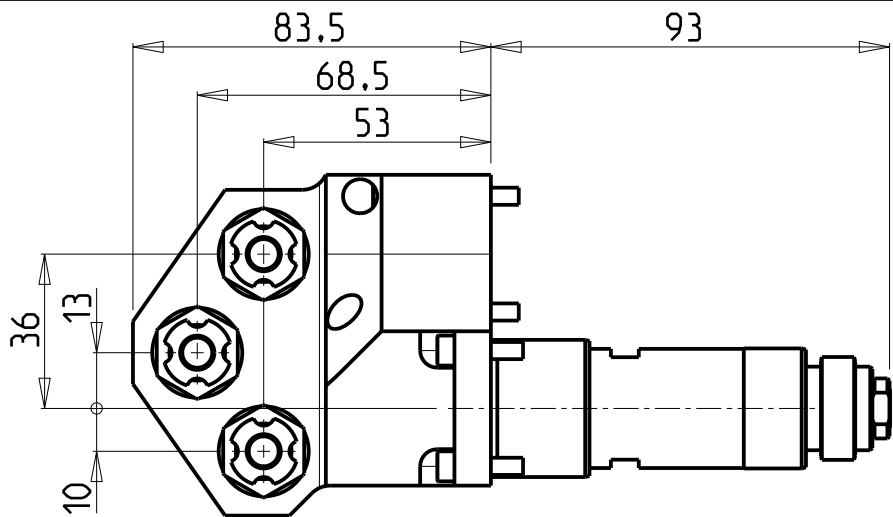

**ATTENZIONE - ATTENTION - ACHTUNG**

- Per lo smontaggio degli utensili utilizzare sempre la chiave di contrasto come indicato nel manuale d'uso.
- For disassembly of the tools use always the contrast key as mentioned in the user instructions.
- Fuer das Abmontieren der Werkzeuge immer den Gegenschlüssel benutzen wie in der Bedienungsanleitung erwaeht.

Cod. MT	Mandrino Spindle Spindel	I	RPM	N°Utensili N° Tools N° Werkzeuge	Lubr.esterna Ext. coolant Aussenkehlung	CHIAVI NON INCLUSE Keys not included Schluessel nicht einbegriffen	
SPC0991000	ER11	1:1	6000	3	X	CHMNER11	CHUB19_SP3

NOMURA  
MOD: NN20UB8 - NN25UB8 - NN20U5

MODULO MOTORIZZATO ASSIALE 3 USCITE  
Axial multiple 3 outlet driven tool  
Axial angetriebenes Mehrspindel-Werkzeug 3 Ausgaenge

Subject to change without notice.

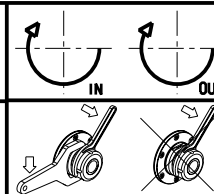

**M.T. srl**  
Via Casino Albini 480  
Tel. 0541/956034-957884  
Fax 0541/956341  
47842 S. GIOVANNI IN M. (RN)  
e-mail: mtma@mtmarchetti.com  
http://www.mtmarchetti.com



PAGINA NOM265-3-10



**ATTENZIONE - ATTENTION - ACHTUNG**

- Per lo smontaggio degli utensili utilizzare sempre la chiave di contrasto come indicato nel manuale d'uso.
- For disassembly of the tools use always the contrast key as mentioned in the user instructions.
- Fuer das Abmontieren der Werkzeuge immer den Gegenschlüssel benutzen wie in der Bedienungsanleitung erwaeht.

-Solo questa uscita è con lubrificazione interna.  
 -Only this outlet is with internal coolant.  
 -Nur dieser Ausgang ist mit IKZ.

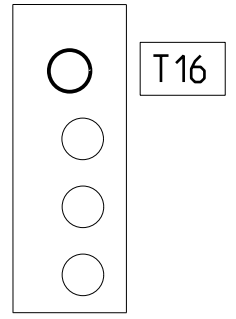
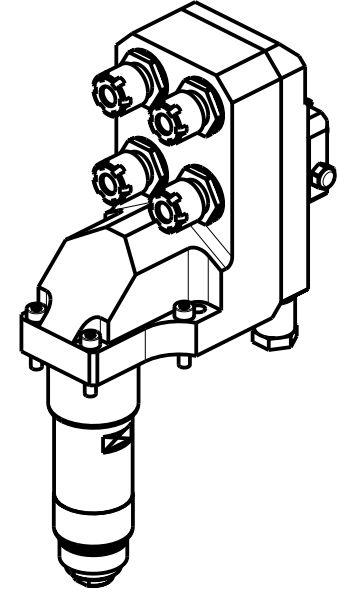
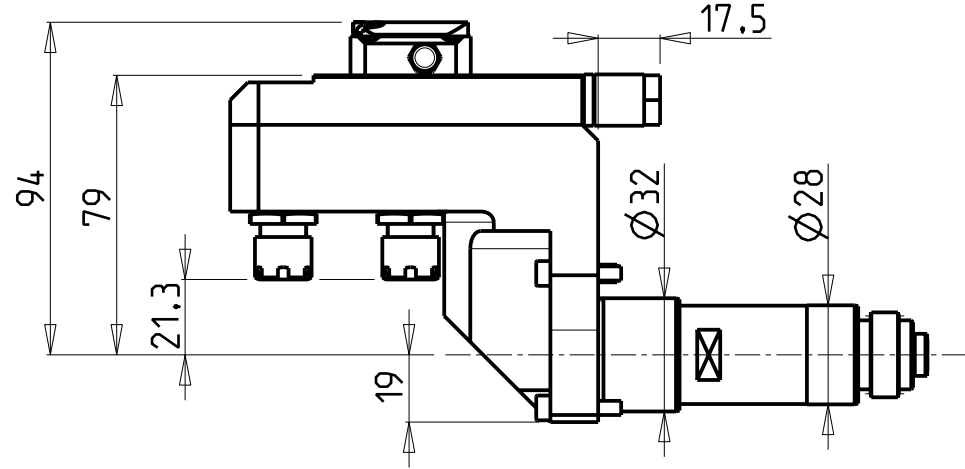
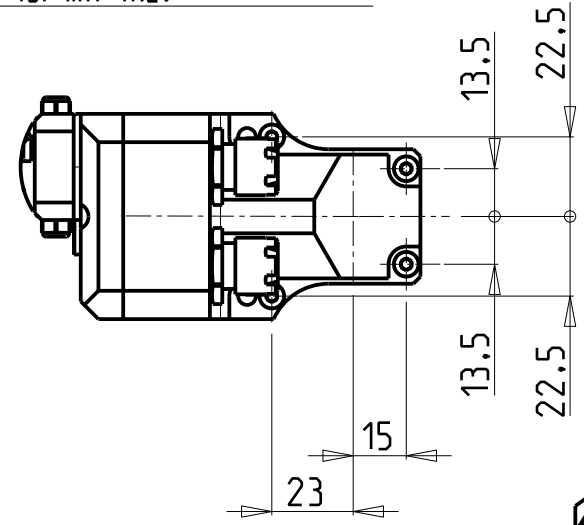
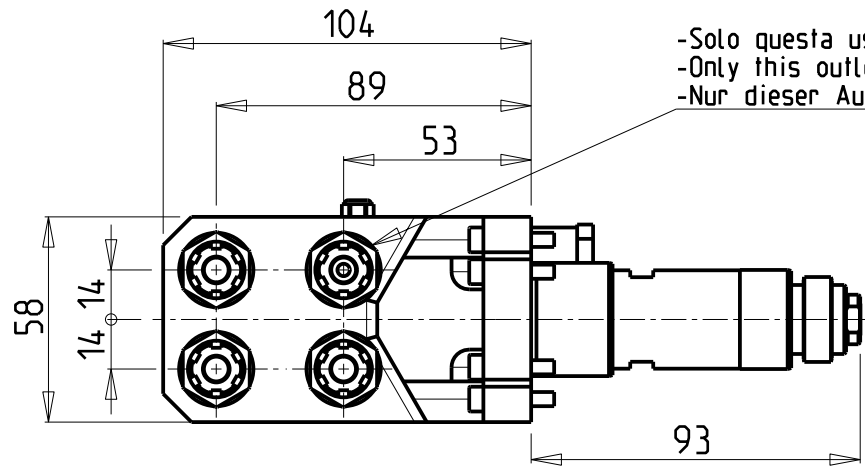

Cod. MT	Mandrino Spindle Spindel	I	RPM	N°Utensili N°Tools N°Werkzeuge	Lubrificazione int. Coolant through Innenkuehlung	Lubr.esterna Ext. coolant Aussenkuehlung	CHIAVI NON INCLUDE Keys not included Schluessel nicht einbegriffen	
NMR0100111	ER11	1:2	12000	4	P=25bar	X	CHMNER11	CHUB19_SP3

NOMURA

MOD: NN20UB8 - NN25UB8 - NN20U5

MODULO MOTORIZZATO ASSIALE 4 USCITE MOLTIPLICATO I=1:2

Axial geared-up I=1:2 multiple 4 outlet driven tool

Axial angetriebenes Mehrspindel-Werkzeug 4 Ausgaenge uebersetzt I=1:2

Subject to change without notice.

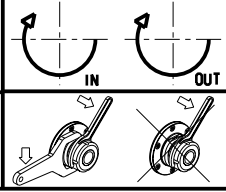

**M.T. srl**  
 Via Casino Albini 480  
 Tel. 0541/956034-957884  
 Fax 0541/956341  
 47842 S. GIOVANNI IN M. (RN)  
 e-mail: mtma@mtmarchetti.com  
 http://www.mtmarchetti.com



PAGINA NOM271-3-00

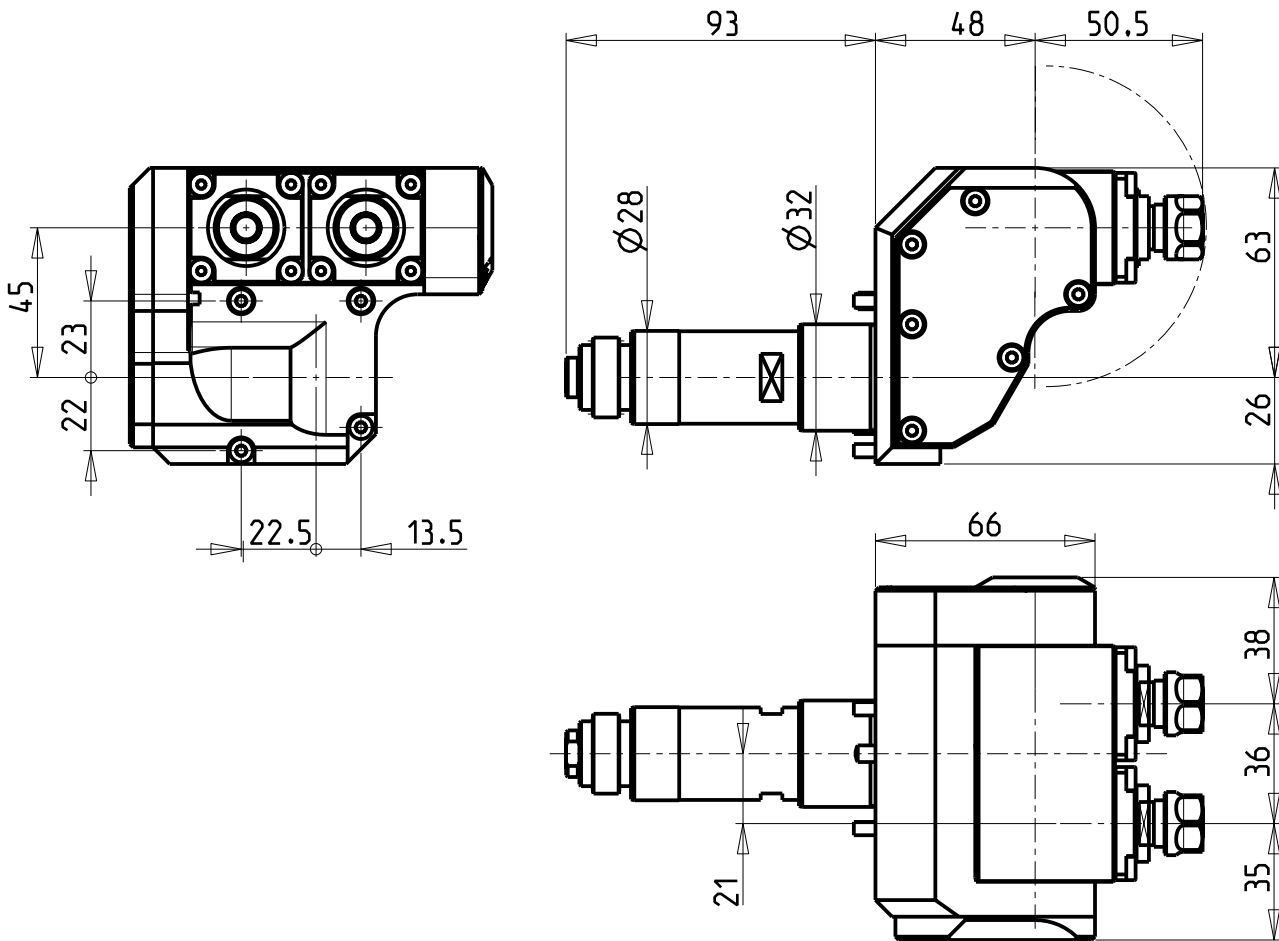

**ATTENZIONE - ATTENTION - ACHTUNG**

- Per lo smontaggio degli utensili utilizzare sempre la chiave di contrasto come indicato nel manuale d'uso.
- For disassembly of the tools use always the contrast key as mentioned in the user instructions.
- Fuer das Abmontieren der Werkzeuge immer den Gegenschlüssel benutzen wie in der Bedienungsanleitung erwaeht.

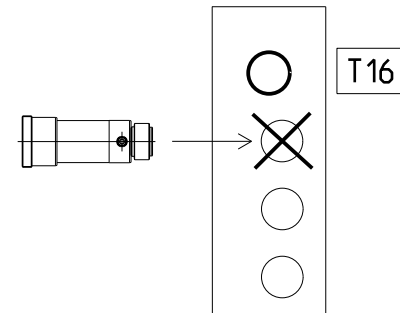
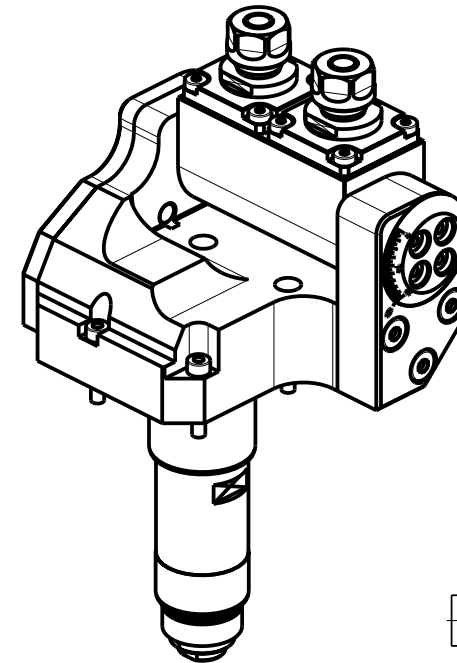

Cod. MT	Mandrino Spindle Spindel	I	RPM	Lubrificazione est. Ext. coolant Aussenkuehlung	CHIAVI INCLUSE Keys included Schluessel inbegriffen
NMR0110211	ER11	1:1	6000	X	CHUB17 CHUB19_SP3

NOMURA  
 MOD: NN20UB8 - NN25UB8 - NN20U5

MODULO MOTORIZZATO ORIENTABILE DOPPIO ±90°  
 ±90° double adjustable angle driven tool  
 Doppel-Angetriebenes Werkzeug schwenkbar ±90°

Subject to change without notice.

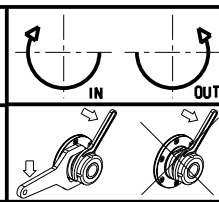

**M.T. srl**  
 Via Casino Albini 480  
 Tel. 0541/956034-957884  
 Fax 0541/956341  
 47842 S. GIOVANNI IN M. (RN)  
 e-mail: mtma@mtmarchetti.com  
 http://www.mtmarchetti.com



PAGINA NOM338-3-00

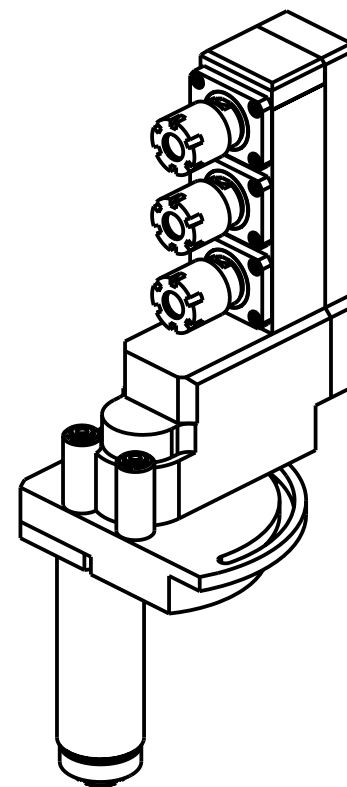
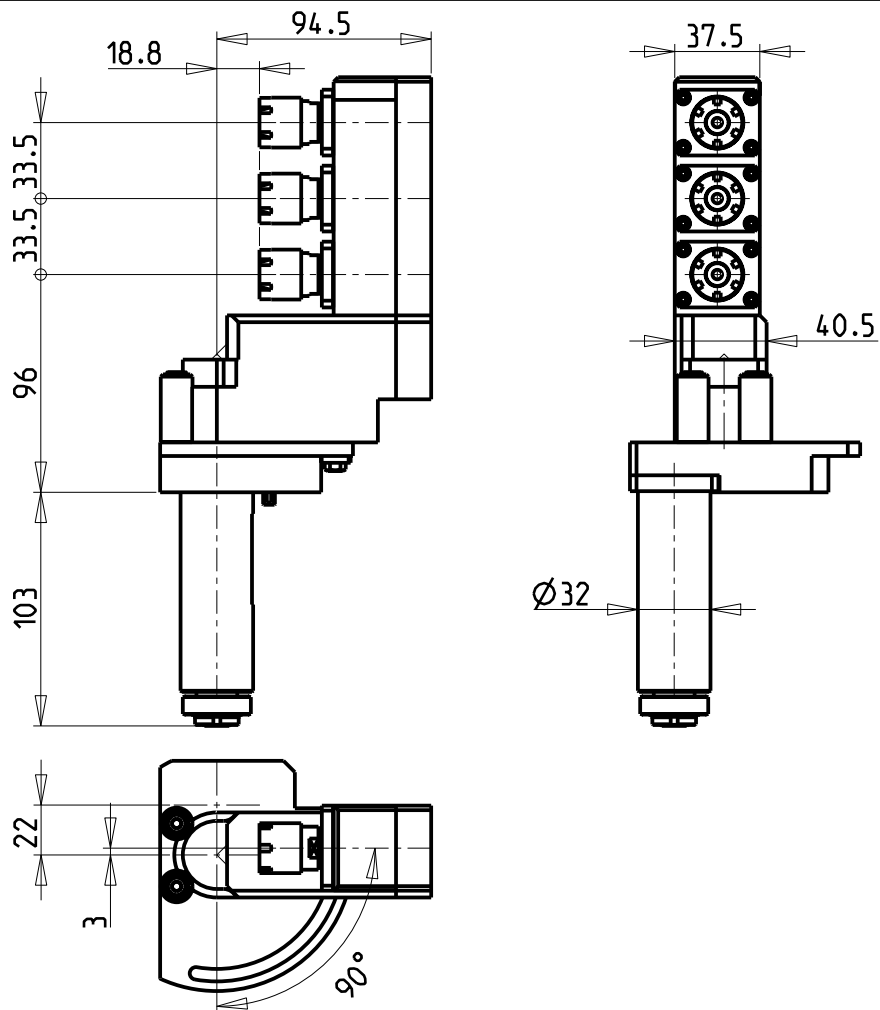

**ATTENZIONE - ATTENTION - ACHTUNG**

- Per lo smontaggio degli utensili utilizzare sempre la chiave di contrasto come indicato nel manuale d'uso.
- For disassembly of the tools use always the contrast key as mentioned in the user instructions.
- Fuer das Abmontieren der Werkzeuge immer den Gegenschlüssel benutzen wie in der Bedienungsanleitung erwaeht.

T9

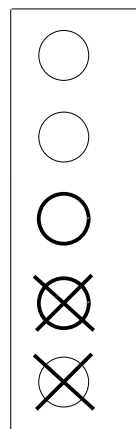

Cod. MT	Mandrino Spindle Spindel	I	RPM	Lubrificazione est. Ext. coolant Aussenkuehlung	CHIAVI NON INCLUDE Keys not included Schluessel nicht einbegriffen	
NMR0150316	ER16	1:1	6000	X	CHUB17	CHMNER16

NOMURA  
MOD: NN38KM

MODULO MOTORIZZATO ASSIALE ORIENTABILE 0/90°  
0/90° axial adjustable angle driven tool  
Axial angetriebenes Werkzeug schwenkbar 0/90°

Subject to change without notice.

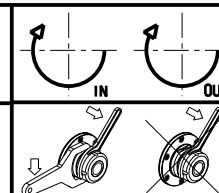

**M.T. srl**  
Via Casino Albini 480  
Tel. 0541/956034-957884  
Fax 0541/956341  
47842 S. GIOVANNI IN M. (RN)  
e-mail: mtma@mtmarchetti.com  
http://www.mtmarchetti.com



PAGINA NOM183-4-10

